

Section V:

**STATE COUNCIL OF HAWAIIAN
CONGREGATIONAL CHURCHES**

HANDBOOK



STATE COUNCIL OF HAWAIIAN CONGREGATIONAL CHURCHES
ANNUAL MEETING
JUNE 07, 2018

COMMUNITY CHURCH OF HONOLULU
HONOLULU, HAWAII

**STATE COUNCIL OF HAWAIIAN CONGREGATIONAL CHURCHES
(SCHCC) - ANNUAL MEETING
June 07, 2018**

Community Church of Honolulu
Honolulu, Hawaii

TABLE OF CONTENTS

Table of Contents	2 – 3
Ron Williams, Senior Minister, Community Church of Honolulu	4
Map of Community Church of Honolulu	5
‘Aha Iki Schedule 2018	6 - 7
Agenda	8 – 9
Annual Meeting Minutes - June 15, 2017	10 - 14
Financial Report:	
Treasurers Report: FY 2017-2018	15 - 16
Proposed Budgets: FY 2018-2019	17 - 18
Committee Reports:	
Repair & Maintenance of Small Membership Hawaiian Churches	19 - 20
Kahu Richard W. Wong Endowment	21
William Kahuakai Keliioomalu Scholarship Fund	22
Katherine & Clay Wery Fund	23
Na Lima Hoike “E” (AHEC Programs Committee)	24
Annual Reports:	
Kauai Council	25
Oahu Council	26 - 28
Molokai Topside	29 - 30
Maui Council	31 – 32
East Maui Hawaiian Ministry	33
West Hawaii Council	34
East Hawaii Council	35 - 36
AHEC - Association of Hawaiian Evangelical Churches	37 - 39
Pu’a Foundation	40 - 42
Hawaii Conference UCC	43 - 46

President	47 - 48
Advisor	49 - 50
SCHCC Directory - (2016-2018):	
Board of Directors / Resource / Partnership Ministries / Conference Staff	51 - 54
Member Churches	55 - 58
New Membership Procedures	59
SCHCC Constitution & Bylaws	60 - 69
SCHCC Brochure	70 - 71
Grant Applications	
SCHCC Repair & Maintenance of Small Membership Hawaiian Churches	72 - 77
SCHCC Kahu Richard W. Wong Endowment	78 - 82
SCHCC William Kahuakai Keliihoomalu Scholarship	83 - 86

Welcome!

Community Church of Honolulu, along with UCC Judd Street and Nu`uanu Congregational Church welcome the delegates and churches of the Hawai`i Conference of the United Church of Christ's 196th 'Aha Pae'aina. We are delighted to open our church's `āina to you our sisters and brothers in Christ. It is our hope and prayer that this will be a time of deep fellowship as we affirm the bonds that bind us together. Let us stand in mutual support for each other as we jointly move into the future.

We invite you to be fully present and enjoy all that takes place in these few days at the `Aha. If you have any special needs or concerns, please do not hesitate to ask. Designated hospitality hosts will be among you, willing to help within our capacity.

May we truly sense and rely on God's presence in our times together.

The Reverend Ron Williams

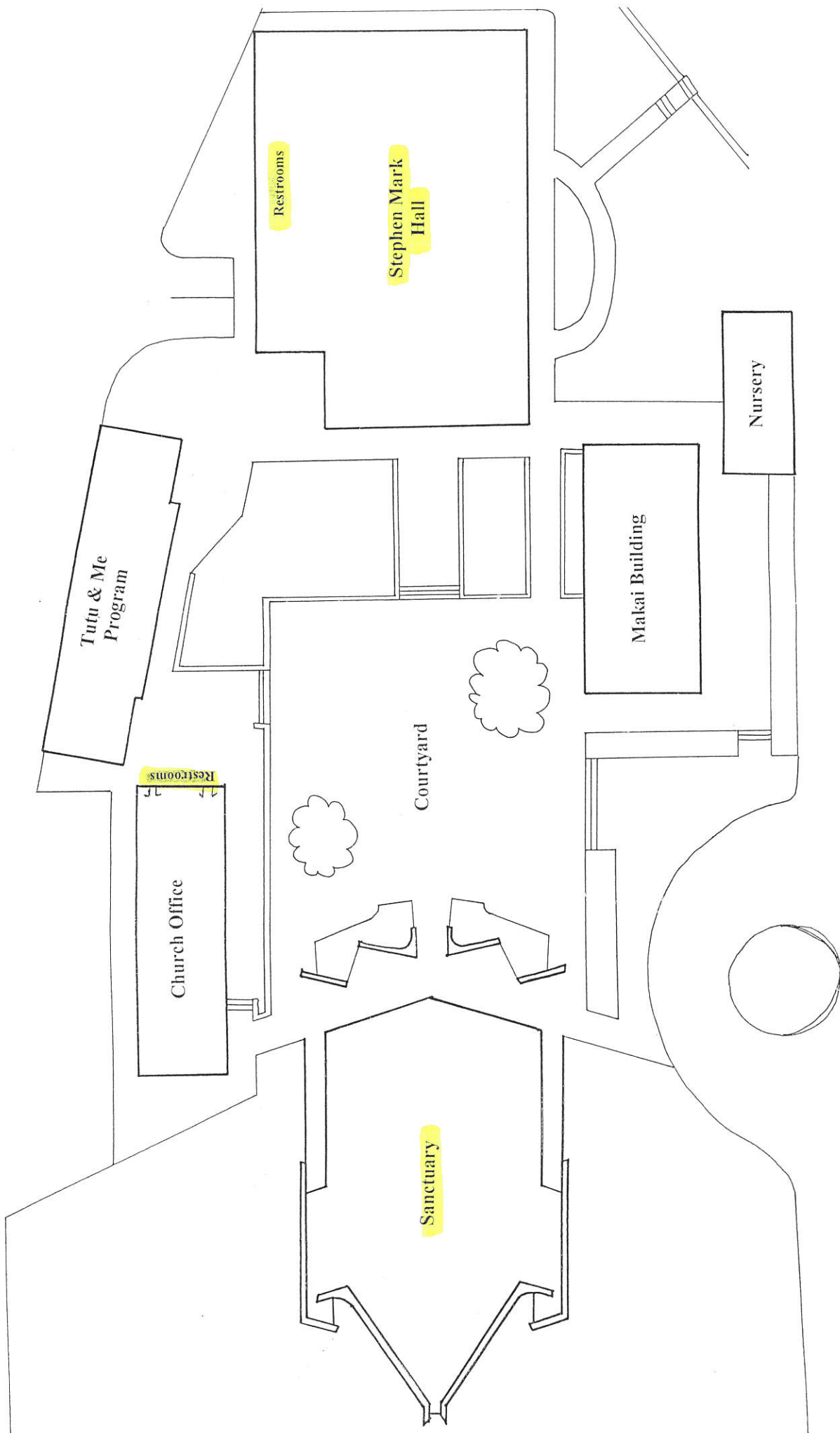

2018 'Aha Iki Schedule

(Subject to Change)

WEDNESDAY – JUNE 06, 2018

7:30 A.M.	Airport Shuttle
8:15	Airport Shuttle
8:00 – 9:45	Registration Breakfast (Sponsored by SCHCC)
10:00 – 11:30	Official Welcome - Opening of 196 th Aha Pae'aina Welcome by Community Church of Honolulu, Host Opening Worship Service of Remembrance (Necrology) End of worship
11:30 – 12:00 Noon	Late Arrivals Registration
11:45 – 12:30 P.M.	Lunch (Sponsored by CE)
12:45 – 2:00	State Sunday School Association Annual Meeting Elections
2:00 – 2:20	Break
2:30 – 5:00	Association of Hawaiian Evangelical Churches Aha Na Kai Ewalu 2018 (Annual Meeting) Elections
5:00 – 6:15	Dinner (Sponsored by AHEC)
6:15 – 7:30	Hoike (Hosted by SSSA)
7:40 – 7:50	Shuttle from Community Church of Honolulu to Pagoda Hotel

2018 ‘Aha Iki Schedule

(Subject to Change)

THURSDAY – JUNE 07, 2018

6:00 A.M.	Shuttle from Pagoda Hotel to Community Church of Honolulu
6:30 – 7:30	Morning Worship Service (Hosted by CEH)
7:45 – 8:30	Registration Breakfast (Sponsored by SCHCC)
8:45 – 11:20	State Council of Hawaiian Congregational Churches Annual Meeting Elections
11:30 – 12:30 P.M.	Lunch (Sponsored by SSSA)
1:00 – 2:30	Christian Endeavor Hawai‘i Annual Meeting (No Elections)
2:45 – 4:15	Closing Worship Installation of Officers (AHEC/SSSA/SCHCC) Communion
4:30 – 5:30	Dinner (Sponsored by Oahu Hawaiian Churches)
5:45 – 7:00	Mele Ho‘onani (Hosted by AHEC/SSSA/CEH/SCHCC)
7:10 – 7:30	Shuttle from Community Church of Honolulu to Pagoda Hotel

State Council of Hawaiian Congregational Churches

Annual Meeting

AGENDA

June 07, 2018

Community Church of Honolulu

1. CALL TO ORDER B. Matsuyama
2. OPENING PULE/OHANA/LULU* S. Matsuyama
(* Please make checks payable to SCHCC)
3. ROLL CALL / QUORUM: Yes ___ / No ___ A. Kaohi
Member Churches: _____ Partnerships: _____
4. GREETINGS B. Matsuyama
5. ADDITIONS TO AGENDA B. Matsuyama
 - 5.1.
 - 5.2.
 - 5.3.
6. 2017 ANNUAL MEETING MINUTES June 15, 2017 A. Kaohi
7. FINANCIAL REPORT F. Mulec
 - 7.1. Annual Treasurer's Report
 - 7.2. Proposed Budget FY 2018 - 2019
 - 7.3. Other
 - 7.3.1. Kokua Mau FY 2018 - 2019
 - 7.3.2.
8. COMMITTEE REPORTS
 - 8.1. Repair & Maintenance - Small Membership Hawaiian Churches K. Alika
 - 8.2. Kahu Richard Wong Endowment A. Trout
 - 8.3. William Kahuakai Keliihoomalu Scholarship S. Matsuyama
 - 8.4. Katherine and Clay Wery Fund S. Lum
 - 8.5. Nominations I. Kaauwai
 - 8.6. AHEC – 5E's Program B. Matsuyama
9. ISLAND COUNCIL REPORTS
 - 9.1. Kauai Council I. Kaauwai
 - 9.2. Oahu Council K. Hess
 - 9.3. Molokai Topside Council U. Sai
 - 9.4. East Maui Hawaiian Ministry N. Cabatbat
 - 9.5. Maui Council A. Trout

- | | |
|---|--------------|
| 9.6 West Hawaii Council | H. Aiu |
| 9.7. East Hawaii Council | E. Mulec |
| | |
| 10. PARTNERSHIP REPORTS | |
| 10.1. PU'A Foundation | T. Bissen |
| 10.2. AHEC | W. Haole |
| | |
| 11. CONFERENCE STAFF / SCHCC OFFICER'S REPORT | |
| 11.1. Intentional Interim Conference Minister | G. Chavez |
| 11.2. AHEC – Papa Makua | |
| 11.3. Advisor | S. Matsuyama |
| 11.4. President | B. Matsuyama |
| | |
| 12. UNFINISHED BUSINESS | |
| 12.1. 501 (c)(3) | F. Mulec |
| 12.2. | |
| | |
| 13. NEW BUSINESS | |
| 13.1. Proposed Budget FY 2018 – 2019 | F. Mulec |
| 13.2. Elections (2018 – 2020) | I. Kaauwai |
| 13.3. | |
| | |
| 14. REFLECTIONS / CONCERNS | |
| 14.1. | |
| 14.2. | |
| | |
| 15. ANNOUNCEMENTS | |
| 15.1. | |
| 15.2. | |
| 15.3. | |
| | |
| 16. ADJOURNMENT_____ / _____ | |
| | |
| 17. CLOSING PULE_____ | |

STATE COUNCIL OF HAWAIIAN CONGREGATIONAL CHURCHES
ANNUAL MEETING
June 15, 2017
Kamehameha Schools Maui

Corrected Copy

1. CALL TO ORDER: The annual meeting was called to order at 9:35 a.m. by President Boyd Matsuyama.
2. PULE OHANA: Sharon Matsuyama, advisor led the `ohana. Message: “Blending talented individuals to work as a team.” Lulu (offering) - \$1,190.18.
3. ROLL CALL: Attendance – Forty-eight (48).
Churches: Forty four (44) member churches. Thirty-eight (38) paid member churches. Twenty-six (26) – present.
Board of Directors: Seventeen (17) – Fourteen (14) present.
Partnerships: AHEC & Pu`a; Two (2) – Two (2) present.
Guests (Non-voting members): Six (6) – present. Four (4) -member churches and two (2) National Office.

QUORUM: established with twenty-six (26) member churches present.

Kaua`i Council: 6 churches – 3 present. Hanapepe Hawaiian Congregational Church, Kapa`a First Hawaiian Church, Ko`olau Hui`ia Protestant Church.

O`ahu Council: 9 churches – 5 present. Bernice Pauahi Bishop Memorial Chapel, Kahikuonalani Church UCC, Kaumakapili Church, Kawaiaha`o Church, Liliu`okalani Protestant Church.

Moloka`i Council: 5 churches – 1 present. Ho`olehua Congregational Church.

Maui Council: 8 churches - 6 present. Ka`ahumanu Church, Keawala`i Congregational Church, Lahuiokalani Ka`anapali Congregational Church, Olowalu Lanakila Hawaiian Church, Pa`ia Hawaiian Protestant Church, Waiola Church.

East Maui Hawaiian Ministry: 5 churches – 3 present. Kalanikahua Hou Church (Ha`iku Protestant), Kaulanapueo Congregational Church, Nahiku Congregational Church.

East Hawai`i Council: 6 churches – 4 present. Haili Congregational Church, Kalapana Maunakea First Hawaiian Congregational Church, Ola`a First Hawaiian Congregational Church, Opihikao Congregational Church.

West Hawai`i Council: 5 churches – 4 present. Helani Congregational Church,

Kahuaha`ao Congregational Church, Lanakila Congregational Church, Puka`ana Congregational Church.

4. GREETINGS: Boyd Matsuyama welcomed everyone, delegates and guests.
5. AGENDA: Addition to the Agenda.
ACTION: M/S/C - Bill Haole/Debbie Wong Yuen. Agenda approved with the addition to -
13. New Business.
 - 13.1. Proposed Budget 2017 – 2018. \$11, 200.
 - 13.2. Katherine and Clay Wery Fund.
6. 2016 ANNUAL MEETING MINUTES– JUNE 09, 2016
ACTION: M/SC - Bill Haole/Debbie Wong Yuen. Ratify the minutes.
7. FINANCIAL REPORT: Frank Mulac's treasurers report included:
 - 7.1. Annual Financial Report
Beginning Balance: July 1, 2016 \$7,041.56
Total Budgeted: \$8,250.00 Under budgeted: \$4,787.79
Total Income: \$10,455.79
Total Expenses: \$10,109.58 Profit: \$3,462.21
ACTION: M/C - Treasurer's Annual Financial Report: FY 2016 – 2017 accepted and placed on
file, subject to audit.
 - 7.2. Proposed Budget 2017 – 2018. \$11, 200. *Defer to New Business 13.1.*
 - 7.3. Kokua Mau: FY 2017 – 2018 Funds Available: Distributed.
 - 7.3.1. Repair & Maintenance of Small Membership Hawaiian Churches-\$40,000
 - 7.3.2. Kahu Richard W. Wong Endowment Fund – \$5,000
 - 7.3.3. William Keli'ihō'omalū Scholarship Fund – \$3,000
 - 7.3.4. Katherine & Clay Wery Fund - \$2,500 (pilot program)
 - 7.4. Member Churches Annual Dues Payment Record: \$50.00 per fiscal year: Distributed
8. STANDING COMMITTEE REPORTS
 - 8.1. Repair and Maintenance of Small Membership Hawaiian Churches:
Kealahou Alika reported. Submitted written report.
 - 8.2. Endowment/Scholarship Committees SCHCC.
 - 8.2.1. Kahu Richard Wong Endowment: Aileen Trout submitted written report.
 - 8.2.2. William Keli'ihō'omalū Scholarship Fund: Sharon Matsuyama submitted
written report.
 - 8.2.3. Na Lima Ho'ike "E" (AHEC Programs Committee) :
Boyd. Matsuyama submitted written report.
9. ISLAND COUNCIL REPORTS
 - 9.1. Submitted a written report: Kaua'i, O'ahu, Maui, West Hawai'i, and East Hawai'i Councils.
 - 9.2. No report: Moloka'i Council and East Maui Hawaiian Ministry.

10. PARTNERSHIP REPORTS: Association of Hawaiian Evangelical Churches and Pu'a Foundation submitted written reports.
11. CONFERENCE STAFF / SCHCC OFFICER'S REPORTS
 - 11.1. Conference Minister Charles Buck added his mahalo to the written report.
 - 11.2. Papa Makua: Ken Makuakane submitted a written report.
 - 11.3. SCHCC President Boyd Matsuyama added to the written report: The Executive Committee recommend investing the Katherine & Clay Wery Fund with the United Church Fund. *Defer action to New Business. 13.2.*
 - 11.4. SCHCC Advisor Sharon Matsuyama, submitted a written report.
ACTION: M/S/C - Bill Haole/Debbie Wong Yuen. All reports: Standing Committees, Island Councils, Partnerships, Conference Staff & SCHCC Officer's reports, accepted and placed on file.
12. UNFINISHED BUSINESS: None
13. NEW BUSINESS
 - 13.1. Proposed Budget: 2017 – 2018
ACTION: M/S/C - Bill Haole/Debbie Wong Yuen. Adopt the Proposed Budget
 - 13.2. Katherine and Clay Wery Fund
ACTION: M/S/C – Bill Haole/Isaiah Ka'auwai. The Executive Committee recommend investing the Katherine & Clay Wery Fund with United Church Fund.
14. REFLECTIONS / CONCERNS: None
15. ANNOUNCEMENTS
 - 15.1. SCHCC Quarterly Meeting Dates: 2017 – 2018
July 22, 2017
October 28, 2017
January 27, 2018
April 27 - 28, 2018
(Three (3) meetings will be held on O'ahu; one (1) on Neighbor Island to be determined).
 - 15.2. June 2018 – Annual Meeting. Host to be announced.
16. RECOGNITION OF OFFICERS: The Rev. Dr. Charles Buck installed the officers & Resource Person.
17. RECESS: A brief recess to set up for "*Piko Ceremony*".
18. PIKO CEREMONY PRESENTATION:

Hali`a Aloha
Cherished Memories
Honoring Kahu Charles Buck

Welina: Greetings – Aletha Kaohi

Pule Ho`maika`i: Prayer of Thanksgiving - Kahu Kealahou Alika.

Olelo iku lani: Boyd Matsuyama shared the history and purpose of our gathering. Our ancestors saw a need to unite the Hawaiian Churches and out of that concern, the State Council of Hawaiian Congregational Churches was established in 1948, 69 years ago, and still a viable organization. SCHCC has benefitted from Kahu Charles Buck's leadership and wisdom. As the host organization SCHCC is a member of the Hawai'i Conference Council of the United Church of Christ.

We gather to express our aloha and mahalo to our pastor, teacher and friend Kahu Buck.

Inspired by Kahu Buck, Keoki Kiwaha, member of Puka`ana Congregational Church, composed a haku mele, "Ka Leo Ku`i Hekili", a gift of admiration and gratitude."

Haku Mele: Ka Leo Ku`i Hekil`i – Composed by Keoki Kiwaha. As Keoki Kiwaha read each line in Hawaiian, Sharon Matsuyama translated in English.

He Pilimai: Kahu Buck was invited to come forward. Aletha Kaohi placed "Piko" in his hands. SCHCC Executive Committee members stood with Kahu Buck. Frank Mulec invited representatives from the seven Island Councils and the two Partners to tie a ti-leaf cordage on to "God's Piko."

Mana`o: Aletha Kaohi – The "Piko" designed with braided green ti-leaves symbolizes connection and protection. When making this sacred "piko", GOD'S PIKO, pause to "mihi" (forgive) and "ma`ema`e" (cleanse) "huikala" (purge) until empty of opala (rubbish)

We believe that we have three "piko", which connects us to the past, present and future.

Past: Crown of the head connects us to ancestors.

Present: Umbilical cord connects us to 'ohana (family).

Future: Genitals connects us to descendants.

It is a pleasure, a privilege and an honor to pay tribute to Kahu Charles Buck. The lyrics of the Haku Mele are woven into God's Piko. For the past thirteen years Kahu Buck has served as Conference Minister, pastor, teacher and friend. As SCHCC's spiritual advisor, Kahu Buck will be missed and we express our aloha through this simple "Piko Ceremony." We are connected for each braided leaf represents a member of the State Council of Hawaiian Congregational Churches.

Makana: The Queen's Song Book.

Haku Mele:"Ka Leo Ku'i Hekili", framed.

Triple Piko – A kukui nut, wrapped with a netting and three (3) puka shells. .

The kukui nut (candle nut) - enlightenment and knowledge.

The mesh/eyes of the net – vision.

The knots of the mesh - connecting to the past, present & future.

The puka shells – the triple piko.

Pule Ho`oku`u: Closing prayer – Kahu Charles Buck.

Pictures of "Piko Ceremony" on file.

19. ADJOURNMENT: M/S/C – Meeting adjourned. Kahea Kaiawe / Keoki Kiwaha.

Recorded by: Aletha G. Kaohi, secretary

APPROVED: Date: _____ Signed: _____

Minutes Corrected: _____

**STATE COUNCIL OF HAWAIIAN CONGREGATIONAL CHURCHES
FINANCIAL REPORT FY 2017 - 2018**

Beginning Balance July 1, 2017

\$9,525.17

<u>INCOME:</u>	<u>Budgeted</u>	<u>July-Sept Actual</u>	<u>Oct-Dec Actual</u>	<u>Jan-Mar Actual</u>	<u>Apr-June Actual</u>	<u>YTD TOTAL</u>
Church Dues, 44 @ \$50	2,200.00	600.00				600.00
Fundraising/Mākeke	2,100.00					0.00
Interest Income/ Wm Crisp Fund	1,600.00	1,742.26				1,742.26
Donations	2,300.00	562.00				562.00
Other Income	3,000.00	189.03				189.03
TOTAL INCOME	11,200.00	3,093.29	0.00	0.00	0.00	3,093.29

<u>EXPENSES:</u>	<u>Budgeted</u>					
Air Fare	6,000.00	1,392.96				1,392.96
Resource Persons	500.00					0.00
Car Rental/Gas/Parking	1,100.00					0.00
Lodging	1,800.00	444.33				444.33
Meals	600.00	65.95				65.95
Office Expense	300.00	70.43				70.43
Host Church Mākana	500.00	100.00				100.00
Miscellaneous Expenses	400.00					0.00
TOTAL EXPENSES	#REF!	2,073.67	0.00	0.00	0.00	2,073.67

Ending Balance September 30, 2017

\$10,544.79

Pū'ā Foundation Mākana 1000.00

Beginning Balance July 1, 2017

\$9,525.17

<u>INCOME:</u>	<u>Budgeted</u>	<u>July-Sept Actual</u>	<u>Oct-Dec Actual</u>	<u>Jan-Mar Actual</u>	<u>Apr-June Actual</u>	<u>YTD TOTAL</u>
Church Dues, 44 @ \$50	2,200.00	600.00	900.00	600.00		2,100.00
Fundraising/Mākeke	2,100.00					0.00
Interest Income/ Wm Crisp Fund	1,600.00	1,742.26				1,742.26
Donations	2,300.00	562.00	724.00	832.00		2,118.00
Other Income	3,000.00	758.64	250.00	520.38		1,529.02
TOTAL INCOME	11,200.00	3,662.90	1,874.00	1,952.38	0.00	7,489.28

<u>EXPENSES:</u>	<u>Budgeted</u>					
Air Fare	6,000.00	1,839.74	1,149.04	2,136.86		5,125.64
Resource Persons	500.00					0.00
Car Rental/Gas/Parking	1,100.00		172.68	320.02		492.70
Lodging	1,800.00	444.33		1,881.76		2,326.09
Meals	600.00	188.78	81.44	247.88		518.10
Office Expense	300.00	70.43	117.72	86.09		274.24
Host Church Makana	500.00	100.00	100.00	100.00		300.00
Miscellaneous Expenses	400.00		100.00	970.00		1,070.00
TOTAL EXPENSES	#REF!	2,643.28	1,720.88	5,742.61	0.00	10,106.77

Ending Balance March 31, 2018

\$6,907.68

State Council of Hawaiian
Congregational Churches

Kōkua Mau

FY 2018-2019

FUNDS:

Fund for Repair & Maintenance of Small Membership Hawaiian Churches	\$40,000.00
--	-------------

Kahu Richard W. Wong Endowment Fund	\$5,000.00
-------------------------------------	------------

William Kahuaka'i Keli'iho'omalua Scholarship Fund	\$3,000.00
--	------------

Katherine & Clay Wery Fund (pilot program)	\$2,500.00
---	------------

<u>TOTAL FUNDS:</u>	<u>\$50,500.00</u>
---------------------	--------------------

State Council of Hawaiian
Congregational Churches
Proposed Budget
FY 2018 - 2019

INCOME:

Church Dues (FY 17-18), 44 @ \$50	\$2,200.00
Makēkē	2,100.00
Interest Income/Wm Crisp Fund	1,600.00
Donations-churches, individuals, Lulu at mtgs.	2,300.00
Other Income, reimbursements	3,000.00
TOTAL INCOME:	<u>\$11,200.00</u>

EXPENSES:

Air Fare: Executive Committee*	\$6,000.00
Resource Persons	500.00
Car Rental/Gas/Parking	1,100.00
Lodging: Executive Committee*	1,800.00
Meals	600.00
Office Expenses	300.00
Host Church Makana, 5 mtgs @ \$100	500.00
Miscellaneous Expenses: unbudgeted, underbudgeted	400.00
TOTAL EXPENSES:	<u>\$11,200.00</u>

(*Pres, VP, Sec, Treas. and Advisor)

Note,(Non Budgeted): Pū'ā Foundation, Makana of up to \$1,000.00 will be drawn from the Common Trust Fund held by the SCHCC.

STATE COUNCIL OF HAWAIIAN CONGREGATIONAL CHURCHES (SCHCC)

SCHCC Committee for the Repair & Maintenance of Small Membership Hawaiian Churches

2018 ANNUAL REPORT

Four grants were approved for the fiscal year 2017-2018. The funds available for disbursement was \$40,000.00. Applications were received from the following churches.

- Kapa‘a First Hawaiian Church, Kapa‘a, Kaua‘i
- Ka Hana O Ke Akua, Wai‘anae, O‘ahu
- Ola‘a First Hawaiian Church, Kurtistown, Hawai‘i
- Kalaikamanu Hou Congregational Church, Kaunakakai, Moloka‘i

KAPA‘A FIRST to HAWAIIAN

Because there was not sufficient funds during the 2016-2017 fiscal year meet the needs of all applicants, the application from Kapa‘a First Hawaiian Church for the repair of the roof of the sanctuary was carried over the 2017-2018 fiscal year. The recommendation to approve a grant of \$18,000.00 was made in light of the need for the repair work to be completed before the Makahiki seasonal rains.

The Board approved the recommendation on July 27, 2017.

KA HANA new O KE AKUA

Ka Hana A Ke Akua submitted an application for the installation of a ADA access ramp to the church. The delivery and installation work is to be done by Hawai‘i Modular Space.

The Committee’s priorities include a serious consideration of repair and maintenance work for churches to be ADA-compliant and EPA-Compliant, it was the recommendation of the Committee that the Board of Directors approve the application for the installation of a new 35’ ADA Switchback Ramp for \$11,115.00. The SCHCC Board of Directors approved the recommendation at its January 27, 2018 meeting.

OLA‘A FIRST HAWAIIAN

Ola‘a First Hawaiian Church returned the unspent portion for a grant that they received in 2017.

The project for 2017-2018 was for termite treatment of the sanctuary and restroom. The cost was \$2,450.00. The church contributed 50% of the cost for the work to be done.

As a member of the Committee and as a member of Ola‘a First Hawaiian Church, Kalei Tong abstained from voting.

SCHCC Committee for the Repair & Maintenance of Small Membership Hawaiian Churches
2018 Annual Report
Page 2

The Committee recommended that the SCHCC Board of Directors approve a grant of \$1,225.00 for the termite treatment of Ola‘a First Hawaiian Church. The recommendation was approved by the Board on January 27, 2018.

KALAIKAMANU HOU The overall cost for the project at Kalaiakamanu Hou Congregational Church was \$35,464.31. The project was a repair and renovation of the social hall of the church. In 2017 structural engineers determined that the church’s foundation had deteriorated to the point that the church structure was no longer sound and safe.

A decision was made to renovate the social hall and to move the worship services to that location. C&P Creations, a licensed contractor, was asked to bid on three separate projects including 1) Church Hall windows;
2) Church Hall flooring; 3) Church Hall painting.

The church’s contribution to the overall cost of the project was \$12,000.00. The church received a grant of \$8,000.00 in 2017. The two grants will make it possible for the church to complete work that will allow the congregation to worship in the social hall.

The Committee recommended that the SCHCC Board of Directors approve a grant of \$9,670.00 for the repair of their social hall. The recommendation was approved by the Board on January 27, 2018.

DECISION MADE Committee members agreed by consensus that all future grantees will be asked to provide a financial statement of all income and expenses upon completion of the project.

REMINDER It was noted that all church applicants will be reminded that any unspent funds from grants that are received are to be returned to the Hawai‘i Conference Foundation. The intent is to provide support to other churches in need.

MAHALO *Mahalo piha* to Kalei Tong and Buddy Maunakea, Committee members, and to the Board members for the commitment all have made to serving our member churches. A narrative report for 2017-2018 will be provided to all member churches at the *‘Aha Iki* in June 2018

The Rev. Kealahou C. Alika, Chairperson
SCHCC Committee for the Repair & Maintenance
of Small Membership Hawaiian Churches

KAHU RICHARD W. WONG

ENDOWMENT FUND

No requests for funding received for FY 2017-2018

William Kahuakai Keliihoomalu Scholarship Fund

(State Council of Hawaiian Congregational Churches)

Sharon Matsuyama, Chairperson

c/o Hawaii Conference United Church of Christ

1848 Nuuanu Avenue Honolulu, Hawaii 96817

(808)- 936-1385

2018 ANNUAL REPORT

Aloha e na hoahanau me na hoaloha,

The “William Kahuakai Keliihoomalu Scholarship Fund” was established as a memorial Scholarship in 1979, following the passing of Licentiate Kahu, William K. Keliihoomalu. The fund was started with a monetary gift of \$25.00 by Mrs. Ada Larrison, a friend of the family, and continued growing with support from members of the Keliihoomalu ‘Ohana, Kalapana Maunakea Congregational Church, and many friends. She requested that this gift be placed in a Custodial Account with the Hawaii Conference Foundation, for the purpose of providing financial aid for seminary, postgraduate and continuing education expenses. When the fund grew to the amount of \$500.00, the State Council of Hawaiian Congregational Churches (SCHCC) was appointed Custodian of this Scholarship fund. The State Council of Hawaiian Congregational Churches turned the funds over to the Hawaii Conference Foundation to be invested, setting a goal of reaching the amount of \$5,000.00, with the intention of using the earned interest income towards the granting of scholarships, for the purpose stated. If no applications are received for funding, the monies will remain in the account to continue earning interest.

REPORT ON COMMON TRUST FUNDS

For the quarter ending: 03/31/2018

Balance:	Book Value	Market Value
	\$14,615.43	\$18,051.25

In 2017, the State Council of Hawaiian Congregational Churches Executive Board proposed a program budget, which would include an allocated amount of \$3,000.00 from the William Kahuakai Keliihoomalu Scholarship Fund. The State Council of Hawaiian Congregational Churches Board of Directors approved the proposal and the allocated amount, thus the birth of “Kokua Mau”. The SCHCC Executive Board currently has responsibility as the William Kahuakai Keliihoomalu Scholarship Fund Committee, and encourages interested individuals to consider requesting financial assistance through the William Kahuakai Keliihoomalu Scholarship Fund. Please refer to the Scholarship Policy for more detailed information. If there are any questions, call the telephone number shown on the letterhead of this report.

Sincerely,

Sharon Matsuyama

Sharon Matsuyama, Chairperson

William K. Keliihoomalu Scholarship

KATHERINE and CLAY WERY FUND

The SCHCC Executive Board continues to work on the guidelines and procedures for this fund

State Council of Hawaiian Congregational Churches
Annual Meeting
June 07, 2018

Report for: AHEC's – Na Lima Hoiike “E”

Following grants approved/denied/Pending from July 1, 2017 to April 17, 2018.

<u>Received</u>	<u>Church</u>	<u>Program</u>	<u>Amount</u>	<u>Refund</u>
06/15/16	Haili	Welsh Sabbatical	3,618.22
04/04/17	Kawaiahao	Back to School Outreach	1,000.00	
06/22/17	Hauoli Kamananao	195 th Aha Paeaina	-----	
06/29/17	Helani	SCHCC BOD Mtg-July 22	101.00	
07/13/17	Kawaiahao	APPA Prayer Assembly	5,000.00	4,000.00
07/14/17	Opihikao	SCHCC BOD Mtg-July 22	159.00	
07/17/17	Kaulanapueo	SCHCC BOD Mtg-July 22	100.00	
07/19/17	Ka Hana O Ke Akua	Kawaiahao Ohana Camp	524.00	524.00
08/28/17	Kawaiahao	Ohana Christmas	3,148.00	235.77
09/05/17	Kauahaa	Aha O Na Kahu/Halawai	689.00	55.00
09/07/17	Helani	SCHCC BOD Mtg-Oct 28	113.00	
09/08/17	Pukaana	Fall Aha Halawai	500.00	
09/13/17	Opihikao	SCHCC BOD Mtg-Oct 28	111.00	
09/13/17	Koolau Huiia	Fall Aha Halawai	552.00	
09/18/17	Ka Hana O Ke Akua	Fall Aha Halawai	227.00	
09/18/17	Kalapana Maunakea	Fall Aha Halawai	274.00	
10/03/17	Lanakila	Fall Aha Halawai	637.00	34.00
12/21/17	Opihikao	SCHCC BOD Mtg-Jan 27	139.00	
01/08/18	Paia	Pule Hamau	1,495.00	
01/08/18	Paia	Spring Aha Halawai	1,170.00	
01/10/18	Koolau Huiia	Spring Aha Halawai	493.00	
01/12/18	Helani	SCHCC BOD Mtg-Jan 27	117.00	
01/18/18	Lanakila	Spring Aha Halawai	272.00	
02/05/18	Ka Hana O Ke Akua	Spring Aha Halawai	300.00	
02/07/18	Kaahumanu	Spring Aha Halawai	290.00	
02/07/18	Kaahumanu	Church Leaders Event	300.00	
02/07/18	Kaahumanu	HIA/HCUCC Clergy Retreat	265.00	
02/28/18	Keolahou	Worshipping God-2 CD		*
03/24/18	Pukaana	SCHCC BOD Mtg 4/27-28		*
04/02/18	Opihikao	SCHCC BOD Mtg 4/27-28		*
04/03/18	Kalapana Maunakea	CE/LTE 5/24-28		*
04/03/18	Haili/Kuhio	CE Spring Camp		*
04/05/18	Kaumakapili	Dr of Ministry @ CTS		*

* Pending review

State Council of Hawaiian Congregational Churches
Executive Board of Directors
Kahikuonalani Church
April 28, 2018

Kaua'i Council of Hawaiian Congregational Churches
Quarterly Report

Our officers are as follows:

President, Isaiah Ka'auwai -Kapa'a First Hawaiian Church
Vice-President, Michael Vidinha -Waimea United Church
Secretary, Bonnie Shimatsu -Hanapēpē Hawaiian Congregational Church and
Treasurer, Naomi Yokotake -Wai'oli Hui'ia Church.
Advisor –Aletha Kaohi, Hanapēpē Hawaiian Congregational Church

Our last scheduled meeting for Sun, April 15, 2018 was cancelled due to the bombardment of heavy rains over the weekend. Please continue to pray for our many residents of the Hanalei to Hā'ena areas and the South Shore of Kaua'i.

Upcoming items to be presented at our 'Aha Mokupuni on Sat, May 19:

- a.Approval of Revisions to our Council's Bylaws
- b.Vote for officers for 2018-2019 term

Aunty Aletha Kaohi continues to work and support 'Ohana o Ni'ihau Church.

Several of our churches attended the Conference's Strategic Initiatives.

Our Spring 'Aha Mokupuni will be held at Waimea UCC on Fri, May 18 ('Aha Mele & Dinner) and Sat, May 19 (KCHCC & KAUCC meetings and couple of workshops).

Pastor Olaf Hoeckmann-Percival made a request with Kahu Charles Buck (prior to his leave) to hold the 'Aha Pae'āina for 2020 at Waimea UCC because Waimea UCC was the first mission station.

Kahu Alpha Goto who served Wai'oli Hui'ia Church for 14 years has retired as of Feb 10, 2018. We wish him a wonderful retirement!

Kahu Barry Mick started a new, 3 year contract with Kapa'a First Hawaiian Church as of Jan 1, 2018.

Ke Akua pū
Isaiah Ka'auwai

President

Oahu Council of Hawaiian Churches
State Council of Congregational Churches Annual Meeting
Friday, April 7, 2018 and Saturday, April 28, 2018
Report Period: November 2017 to April 2018

President:

Vice President:	Ka'iulani Hess	Kawaiaha'o Church
Secretary:	Laurie Kauleinamoku	Liliuokalani Protestant Church
Treasurer:	Joanne Kishimori	Kahikuonalani Church
Advisor:	Della Kua'ana	Kahikuonalani Church

Winogene "Nana" Aiu, went home to our Lord, on 19 Jan 2018. Mahalo Ke Akua for the precious time we were given with Nana as our sister in Jesus.

O'ahu Council of Hawaiian Congregational Churches will be providing and serving the "Spaghetti Dinner and Dessert at the 2018 Aha Iki, Thursday, June 7, 2018.

Bishop Memorial Chapel – no attendance or report received.

Hauula Congregational Church – no attendance or report received.

Ka Hana O Ke Akua Church – Richard Stevens, Jr.

- Received new members; 100 members, lost 5
- No pastor has energized the church; intensifying ministry;
- Aunty Nana Aiu is with our Maker
- Mahalo SCHCC for the grant; ramp is repaired;
- Pastoral Search Committee lost 1/3 of committee due to death's

Kalihi and Moanalua Church – Haleaka Martin

- Kahu: David Kaupu, Manu Naeole, Sherman Thompson, Deacons
- Sunday School Service every 2nd Sunday at Lunalilo Home
- Punana Leo continues Hawaiian immersion Pres-school
- Prayers for AHEC, SCHCC, Christian Endeavor, Women's Board of Missions, PAAM, Martin & Ka'alele 'Ohana for passing of grandson Colin Ka'alele, for individuals on prayer list

Kaumakapili Church – Lorna Motas

- Kahu Douglas Wooten completed his doctorate in Theology; sermons are filled with scripture, practical daily applications and invitations to accept Jesus Christ!
- Rise in attendance of members; many new faces;
- Lenten Bible series started on Ash Wednesday and continued Wednesdays until March 28
- Easter Sunrise and 10:30am Easter Service
- Momi Maunakea and Kahau Schoenstein compiled a book honoring those who contributed to the stain glass windows; dedication of the book and recognition honoring attendees who contributed to the stain glass windows took place during Easter Service.
- Repairs to Hale Kamika downstairs completed; ready for rental and use;

- Lorna Motas and Kahu Wooten attended the Aha Hālāwai at Ola'a in February
- Plans for July Lu'au, leadership and prayer retreats, evening Bible studies in the works
- Passing: Gordon Bright, February 2018

Kawaiāha'o Church – Ka'iulani Hess

- Hebedoma – Week of Prayer January 24-28, 2018
- Ash Wednesday, February 14, 2018
- Maundy Thursday Service, March 29, 2018
- Easter “Son rise” Service and Easter Sunday Service, April 1st
- Four attended the Aha Hālāwai at Ola'a Church, February 9 & 10, 2018
- Service of Ordination and Installation for Kahu Kenneth Makuakane, Saturday, May 5, 2018, 4:00pm, light meal after the service
- Hālāwai, all Hawaiian Sunday Service, 5:00pm, twice a month
- Wednesday Night Prayer, 5:30pm
- Continue to host Ali'i Sundays

Liliuokalani Protestant Church – Laurie H. Kauleinamoku

- Kahu Wally Ryan Kuroiwa
- Liliuokalani Festival, February 3, 2018, Amy Hanaialii, 3 hula halau, vendors
- Shrove Tuesday, February 13, 2018
- Ash Wednesday, February 14, 2018
- Annual Spring Kalua Pig Fundraiser, March 17, 2018, sold out 1500+
- Maundy Thursday, March 29, 2018
- Good Friday joint service at Waialua UCC, March 30, 2018
- Easter Sunday Worship with communion, new membership and baptism
- Guest Kahu in April: Kahu Lauren Buck Medeiros and Kahu JP Sabithi
- Buildings and Grounds committee working on repairs and maintenance request
- One baptism; 2 new members;
- Annual Church Lu'au, August 4, 2018

Pearl City Community Church – Millie Yee and Pat Wong

- Music Festival, Master of Ceremonies, Rodney Villanueva, 17 different acts
- Hawaiian Sunday Worship, last Sunday of the month
- Ongoing food distribution
- Women of Hui Lokahi, Valentine Luncheon, Honolulu International CC
- CPR/AED training
- Visitation Ministry Workshop, “Exploring Different Ways to Pray”, Pastor Hirano
- Palm Sunday Worship Service
- Maundy Thursday Service
- Good Friday Service
- Easter Sunday Service
- White Elephant & Country Store, April 21

Waianae Protestant Church – Marilyn Liftee

- Kahu Hailama Farden honored as Living Treasure of Hawai‘i
- Vacation Bible School – 5 days during school break
- Opio collecting Sunday offering. Will do Scripture and Responsive Readings
- Tongan Church asked to share our sanctuary/hall
- Queen Liliuokalani 100th Commemoration of her death-tolled the bell 100 times
- OSSA Hōike, October 22nd – Kahu Halima represented our church
- Church awarded and listed on the Hawai‘i Register of Historical Place
- Restoration – seeking suggestion, contacts, donations, grant
- OCHCC small repair applications
- Replied to survey from OCHCC
- Vandalism – windows broken on Waikiki side of church – repair in progress
- Umbrella – asking if we have an insurance company or attorney that we could inquire for services

Moloka'i Topside Report for 2017

The year 2017 has certainly gone by so quickly with many good things that transpired at our Topside churches.

First, the congregations from Ho'olehua, Kalaiakamanu Hou, Kalua'aha and Waialua churches are enjoying the ministry of Kahu Charles Poole as interim kahu. His wife, Elaine has been a great partner in assisting Kahu in many ways with his ministry.

Next, Topside officers' term of office ended in July for Chair, Norman Levi, Treasurer, Uluwehi Sai and Secretary, Tina He-Lindsey. New officers were inducted during Combined Services at Kalua'aha in September. The new officers are Co-chairpersons, Pualani Akaka and Earline Iaea, Treasurer, Uluwehi Sai, and Secretary, Tina He- Lindsey.

Under the leadership of Kahu Kordell Kekoa, the Kamehameha Schools Deputation team's visit in January is always a welcomed event at our churches and the congregations looked forward to their visitation. Plans to visit Kalaupapa did not evolve so the group of students and chaperones did a workday at Kalua'aha by weeding inside the church sanctuary and cleaning the cemetery. Their assistance was very much appreciated.

Quarterly combined services held at each church throughout the year started off with Ho'olehua in March, followed by Waialua combined with Ho'ike in June, next, Kalua'aha in September and last of all, Kalaiakamanu Hou in December. A sermon for each combined service by Kahu Poole was very inspirational. All in attendance also enjoyed the onolicious pa'ina after service.

We are very excited that we have a member from Ho'olehua Church who is interested in becoming a minister. The church members are sponsoring Pualani Akaka who is a Member in Discernment, for a license in ministry from the Tri-Isle Association. She is under the mentorship of Kahu Linda Petrucelli. Kahu Poole has also been a great mentor to her. She has been attending various workshops sponsored by the UCC and learning more about the various aspects of our UCC ministry.

Special holidays throughout the year were celebrated with the different congregations and people from the various communities on island. Easter Sunrise service for the early risers at Waialua Church with breakfast after service; Thanksgiving lunch for Kupuna at Home Pumehana and for those who would otherwise be alone with no family to celebrate with on this occasion. This was our first endeavor of preparing and serving a complete Thanksgiving meal, but with Ke Akua's help, donors from Friendly Market and church members we were able to do this service. We were thankful to our chairperson, Uluwehi Sai for chairing this event. December is always a busy month, but Ho'olehua and Waialua churches both held Christmas Eve services which were well attended. Another festive activity enjoyed by the community was the appearance of the Community Choir that included some of our church members who performed at different denominational churches on island.

A focus this past year for Topside Council was Community involvement. Different types of events evolved such as the Thanksgiving Luncheon and Community Choir mentioned in the previous paragraph, free haircuts and mini manicures by Paul Mitchell Salon hairstylists and trainees, family movie nights during the summer months where families could bring their chairs, blankets, food and enjoy the movie outdoors and fellowship with other people on the front lawn of Kalaiaakamanu Hou Church and quarterly Farmers Market held at the Waialua Church pavilion.

Moloka'i has seen more of its share of suicides on island and community members have been meeting to discuss ways to deal with this issue. The goal was to provide hope against the effects of depression, drugs, alcohol, and abuse. Kahu Poole has been attending meetings with other ministers and community leaders and reports back to Topside Council. Various activities included sign waving, whole island involvement with an Island Walk starting from East and West Moloka'i and ending with a rally at Kaunakakai Public Library. Meetings will continue in 2018.

Last of all, Waialua church members were so grateful for grant monies received from SCHCC that enabled them to renovate the old church building into a Sunday School Building. This renovated building was named Arthur and Winnie Naehu Sunday School Building and dedicated in June 2017. Keiki and makua are making good use of this beautiful renovated space for Sunday School classes. Another happy recipient of grant monies is Kalaiaakamanu Hou Church who will use the funds for renovations to the Social Hall in anticipation that the church sanctuary might not be safe for occupation within 1 – 2 years. Mahalo to the SCHCC for making grant monies available to the churches for repair and maintenance.

The Topside Council of Moloka'i will be doing their best to continue representing their congregants and work together to do God's ministry on island.

Sincerely,
Earline Iaea
Co-chair
Moloka'i Topside Council

Report of the Maui Council of Hawaiian Congregational Churches

April 17, 2018

Ka`ahumanu Congregational Church

Wayne Higa is Kahu Pono. Work continues in the renovation of Ka`ahumanu Church. On January 28, 2018, King Lunalilo was commemorated on Ali`i Sunday. On March 18, 2018 Ahahui `O Ka`ahumanu, the Royal Order of Kamehameha, and Hale o Na Ali`i celebrated the **250th birthday of Ka`ahumanu**. Ho`ike was held on April 7, 2018. Annual Pulelu Fundraiser will be on April 21, 2018.

Kahakuloa Hawaiian Congregational Church

In June 2017, the roof of the church collapsed leaving the foundation and 1 wall intact. With the help of the community, church leaders, and donated manpower from construction companies, the debris was removed and work began on the foundation and walls. In March the roof was in place, With the leadership of Kendall (Chico) Ka`onohi, the congregation hopes to reopen the church on June 11, 2018, 1 year after the collapse.

Sadly, **Uncle Richard Ho`opi`i, passed away in early March**. There was a service for Uncle Richard in Kahakuloa on March 26. Ho`olaule`a is planned for May 5, 2018.

Keawala'i Congregational Church

Reverend Kealahou Alike is the pastor. Church services are at 8:30 and 10:00 AM on Sundays. Their annual luau in March, as always, was enjoyed by kama`aina and malihini.

Keolahou Congregational Hawaiian Church

Keolahou Congregational Hawaiian Church continues to hold Sunday worship services with supply preachers from the community. Our weekly Food Pantry mission continues with excellent support from members, clients, other community individuals and church partners. We serve an average of 130 households. We also provide a dinner meal monthly for those at the Wailuku Homeless Shelter, Ka Hale A Ke Ola.

Our support of Hawaiian culture and values is demonstrated by our sponsoring of weekly Hula lessons under the leadership of a local Halau Na Pua o Kaiwa and Kumu Noelani Forsberg and a weekly ukulele/Hawaiian songfest under the direction of "808ukejams" Kumu, Kealoha Delos Santos. We have experience a 15% increase in

membership since last year and our budget support remains strong and which will allow us to proceed with hiring half-time pastoral leadership in 2008.

Lahuioakalani Ka'anapali Congregational Church

Originally known as Ka'anapali Congregational Church, Lahuioakalani Ka'anapali Congregational Church was established in 1840. The foundation for the church has always been **lay leadership**, and that tradition continues today. Join us for Sunday services at 10 AM. The highlight for this year: we are ready to rebuild the Hale 'Ai.

Olowalu Lanakila Hawaiian Church

It has been a quiet time for our church and congregation since the beginning of the year. Attendance has been steady. Kenneth Makuakāne paid a visit to our church last month and shared a typically wonderful message with our congregation.

We have a new church website, that can be found at <https://olowalulanakilahawaiianchurch.wordpress.com/> and we are on the map, Google Maps that is, at Olowalu Lanakila Hawaiian Church. We are looking forward to the April 27th State Council visit.

Pa'ia Hawaiian Protestant Church

Kahu Roy Newton is the pastor. Services are at 11:00 AM. Pa'ia hosted AHEC Halawai in October, 138th Anniversary and Ho'ike in November, Candle-lit Christmas Eve, and sunrise services on Easter. In March Pa'ia commemorated Prince Jonah Kuhio with Royal Order of Kamehameha.

Mission work: this year, the church launched a new outreach program to feed the homeless in the community.

Waiola Church

Anela Rosa is Kahu Pono. On June 10, 2018, the Royal Order of Kamehameha and Ahahui 'O Ka'ahumanu will be present at Waiola to honor Keopuolani, sacred wife of King Kamehameha. This year **Waiola will celebrate its 195 Anniversary in September 2018.**

Kaulanapueo Church
110 Malanani Drive
Kula, Hawaii 96790

February 27, 2018
March 13, 2018
April 15, 2018

Boyd Matsuyama
State Council of Hawaiian Congregational Churches
P.O. Box 407
Holualoa, Hawaii 96725

Aloha Boyd,

I take computer and printer in hand to let you and the State Council of Hawaiian Congregational Churches know that the East Maui Hawaiian Ministry has as of Sunday February 25, 2018 dissolved. We started out with Keanae Congregational Church, Nahiku Congregational Church and ourselves, Kaulanapueo Congregational Church. Over the years Wananalua in Hana and Kalanikahua Hou joined East Maui Hawaiian Ministry. Times and needs have changed.

We have been in touch with Aileen Trout and are trying to find out how to join the Maui Council.

Altho we no longer have the EMHM (the East Maui Hawaiian Ministry) we will still be holding our na hoike. We have moved the date from March to May.

Mahalo nui for your patience and counseling. Take care and Blessings be.

Boyd Matsuyama

cc: Kelson Namahoe
Aletha Kaohi
Aileen Trout

STATE COUNCIL OF HAWAIIAN CONGREGATIONAL CHURCHES

WEST HAWAII COUNCIL OF HAWAIIAN CONGREGATIONAL
CHURCHES

ANNUAL REPORT

June 07, 2018

West Hawaii Council continues to meet for the betterment of the member churches. The Council meet to identify and find solutions to the concerns and needs of our Hawaiian Churches. Our meetings also enhance member churches' understanding of the purpose and mission of the State Council Of Hawaiian Congregational Churches and the Hawaii Conference United Church Of Christ.

Member Churches:

Hauoli Kamanao – Milolii

Sunday: Bible study 10:40 am – Worship 11:00 am

Monday: Bible study 6:00 pm

Pulpit Coverage: Na Kahu Pono Mahina and Melveen Kaupiko

Helani – Kahaluu Mauka

Sunday: Worship service 10:00 am – Children Sunday School 10:30 am

Pulpit Coverage: Guest Kahu, guest speaker and church worship leaders

Kahikolu – Church litigation continues

Pulpit Coverage: Pastor Naleen N. Andrade

Kauaha'ao – Waiohinu

Sunday Worship service 10:00 am

Pulpit Coverage: Kahu Pono Debbie Wong Yuen

Lanakila – Kainaliu

Sunday Worship service 9:00 am

Pulpit Coverage: Kahu Pono Charlene Taketa

Puka'ana – Kealia

Sunday Worship service 8:30 am

Pulpit Coverage: Guest Kahu, guest speaker and members

Blessings to All,
Harry Aiu, President
West Hawaii Council Of
Hawaiian Congregational Churches

REPORT OF THE EAST HAWAI'I COUNCIL OF HAWAIIAN CONGREGATIONAL
CHURCHES
STATE COUNCIL OF HAWAIIAN CONGREGATIONAL CHURCHES
Annual Meeting, 'Aha Iki
Community Church of Honolulu
June 7, 2018

Aloha na hoahānau,

The East Hawai'i Council Member Churches include:

Haili Congregational Church / Kuhio Chapel	'Opihikao Congregational Church
Kalapana Maunakea Congregational Church	Pōhakupuka Congregational Church
Laupāhoehoe Congregational Church	Pu'ula United Church of Christ
Ola'a First Hawaiian Church	

The East Hawai'i Council meets quarterly on Saturday mornings and was held on July 1st, Sept. 30th, Nov. 11th 2017, Jan. 20th and April 14, 2018. Distribution of materials are made available with discussions about the items of concerns from the last SCHCC BOD meeting held along with advocating to the East Hawai'i Council Churches needs.

The new officers of this Council are: President Frank Mulec, 'Opihikao Cong. Church
Vice President Clem Malani Jr., Laupāhoehoe Cong. Church
Secretary Margaret Loke Kamanu, Kalapana Maunakea Cong. Church
Treasurer Elizabeth Liz Salfen, Pu'ula UCC
Auditor Judith Bailey, Ola'a First Hawaiian Church

- **Haili Cong. Church/ Kuhio Chapel**

Haili House of Prayer, 8:00 AM Haili Ohana Hour, 8:30 AM Haili Service, 11:00 AM
Kuhio Service, 9:30 AM

- **Kalapana Maunakea Cong. Church**

We continue to feed the hungry in Puna every 2nd Friday and so many families come out and we are able to share the word and love of God as well with them. Our youth continue to hold service every 5th Sunday

- **Laupāhoehoe Cong. Church**

Praise, worship and singing continues at Laupāhoehoe Congregational Church every Sunday.
CE starts 09:30 am and worship service concludes around noon followed by lunch in the hall.

- **Ola'a First Hawaiian Church**

Kahu Lani Kapuniai continues to serve as Pastor. Sunday service begins with Praise and Worship at 10:00a.m. and Worship Service at 10:15 a.m.
The hall roof was repaired and painted in 2016/17. In 2017, Repairs to the church restroom building took place. Also submitted a grant request to the SCHCC to help with the cost of termite treatment of the sanctuary building and church restroom building. Termit treatment

took place on the 9th of March 2018. According to records, the sanctuary building is close to ninety years old, with more repairs and restoration work needed.

- **‘Opihikao Cong. Church**

Continued to be served by Kahu Pono Harriet Clara Daog. Worship Service at 11:00 AM
Will be replacing the roof on the multi-puprose (old hale hiamoe) building and future termite treatment of the sactuary, social hall and multi-purpose buildings.

- **Pōhakupuka Congregational Church**

- **Pu‘ula UCC**

The church is continuing to be blessed with Hawai‘i Electric Light Co. working on the sancuary lighting and by a bulldozer operator providing time and labor to help clear some of the church property

NECROLOGY:

- **Haili Cong. Church/ Kuhio Chapel**

Elson “Bobo” Kanaina Brown Jul. 22, 2017
Shepherd Kauohilo Lainaholo Oct. 19, 2017
Ellen “Tita” Haumealani Lainaholo Oct. 21, 2017
Zelda Lainaholo Kelson Nov. 21, 2017
Herman Naha Ludloff Jr. Jan. 19, 2018
Albert Ernest Pung Jan. 13, 2018

- **‘Opihikao Cong. Church**

Consuelo Calonsai Daog Aug. 2 , 2017
Haroleen Puena Makuakane Aug. 22, 2017

Mahalo Ke Akua,

Frank J Mulec

Frank J. Mulec, President

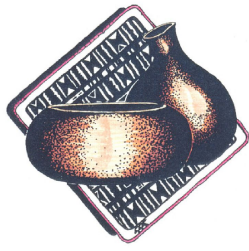

Association of Hawaiian Evangelical Churches
Hawai'i Conference United Church of Christ
1848 Nu'uuanu Avenue
Honolulu, Hawai'i 96817
Phone 808-537-9516

Luna Ho'omalua Annual Report
196th 'Aha Pae'aina
June 6-9, 2018
Community Church of Honolulu
Honolulu, HI.

My Goals As Luna Ho'omalua of AHEC

- Meet and create relationships with as many AHEC and Kalawina individuals and churches possible. (Progress? Although successful with the mainstream AHEC churches, I am still working on other Kalawina. I will continue to seek opportunities to continue and to expand on this Goal.)
- Continue to be open to learning opportunities and responsibilities of the Luna Ho'omalua and advocating for consistent and progressive growth of the Body of Christ within our Association and all denominational and ecumenical partners in Christ.
- Advocate for continuing educational opportunities and workshops to keep all Kalawina informed and focused on the Mission and Goals of the Association of Hawaiian Evangelical Churches.
- Ensure the Association is fiscally responsible and sound Stewards of financial resources provided by Ke Akua.
- Advocate for the creation of a UCC Council for Native Hawaiian Ministry to continue building relations between the UCC and Native Hawaiians.
- To support efforts of our AHEC Committee on Ministry to create local educational opportunities and or make available affordable, accessible and multiple educational pathways to encourage and prepare laity for ordained Ministry.
- To work closely with Partnership Ministries, providing mutual support and common goals to lift up the conditions of Hawaiian and all of God's people.

What Was Actually Accomplished?

- The work of meeting and creating relationship with AHEC Kalawina and other Hawaiian Churches and individuals has been somewhat successful during 'Aha and or actual island visitations. However, this work never ends and continues.
- I've learned so much and have a tremendous appreciation for all the Luna Ho'omalua that preceded me. One can never be prepared for the day to day, month to month and year to year tasks that come up while being the Luna Ho'omalua. However, I continue to do my best to meet and or exceed expectation of me as the Luna Ho'omalua of AHEC.
- We continue to search through old records and minutes, historical documentations and every resource available to understand what our Kūpuna envisioned during the creation of the Association of Hawaiian Evangelical Churches and began archiving and providing this information in 'Aha and 'Aha Nā Kahu workshops and other training opportunities as much as possible. These documents have also been valuable to our current work on our bylaws, introduction of new policies and visioning discussions over the past two years.
- In 2016, the Association approved the formation of an Investments Ad Hoc Committee to explore and or develop and create an Endowment Policy Statement that gives clear directions on how this Association manages and distributes its endowments. After going through several revisions this

policy was finally adopted at the February 10, 2018 Fall ‘Aha Hālāwai at Ola‘a Church. Also, our current Pu‘ukū, Kerisa Carmello shared excellent and important training with our Board on how to read and review financial reports of the Association, something I hope will be continued in the future.

- It was my hope to attend the last General Synod to begin discussion with delegates UCC Staff members responsible for the development and creation of the UCC Council for American Indians for guidance in the creation of a UCC Council for Native Hawaiians. Much was accomplished since the UCC’s “Apology to the Kānaka Maoli” address made by General Minister, the Reverend Dr. Paul Sherry, on January 17, 1993 to the Indigenous Hawaiian People on the grounds of ‘Iolani Palace. The work is not over and fostering and building this work for the benefit of our Hawaiian people and churches with the United Church of Christ should continue as they have for our Native American Sisters and Brothers.
- The AHEC Committee on Ministry has worked hard these past few years with changing times and leadership. The COM has progressed into a great team addressing reforms in providing quality educational opportunities through mentorship, workshops, and curriculum development to inspire laity to ordination, including through the opportunities provided through multiple pathways for Ministerial Excellence, Support and Authorization. Currently, the Association will have ordained two Kahu (Kahu Mike Warren and Kahu Ken Makuakāne) and have six Members in Discernment.
- Fostering good relationships with our Partnership Ministries has been God driven. As Luna Ho‘omalū, I’ve advocated for stronger relations with all Partnership Ministries, ensuring then and for the future, growth and sustainability together as One Body of Christ. It is important to remember what the Apostle Paul wrote in 1 Corinthians 1:9, “You were called into the fellowship of His Son, Jesus Christ our Lord.” This means sharing vertically and horizontally in the union each of us has in Christ and “sharing” together with other believers the common union we have with Christ and each other. That being the sharing together in the Father and the Son as in 1 John 1:3, “That which we have seen and heard we proclaim also to you, so that you too may have fellowship with us. . .”

In Conclusion

We must never forget the founding principles of the Association of Hawaiian Evangelical Churches. In his report on the on the creation and development of AHEC, Kahu Merseberg wrote:

“ . . . the Association of Hawaiian Evangelical Churches is the fulfilment of a dream which evolved through a growing process which began with the HCUCC Hawaiian Ministry Department and which included our Hawaiian Churches and Ministers and all HCUCC Hawaiian Groups in each part of the journey.

AHEC came about because our people wanted it to happen. The entire ohana or family of Hawaiian organizations in the HCUCC participated in all stages of AHEC’s development; namely, the proposal writing, the interim governing board work, the Mission Statement development, the By-laws development and approval. Our people worked hard to make it happen.

AHEC is an expression of commitment on the part of our people to accept the responsibilities of a fully participating self-determining Association in the HCUCC. It’s a means by which to empower ourselves to be solution makers for Hawaiian concerns inside and outside the Church. It’s an instrument or conduit through which resources can flow to and from our churches. It’s an agent to help encourage and strengthen our churches and our leadership, laity and clergy, to be faithful in God’s mission. It’s an official participant in the HCUCC BOD decision making.”

Our work continues with many hills and valleys behind us, before us and yet to come. However, by the Grace of God, who is still speaking in our hearts we continue to make strides to ensure God's presence through Jesus Christ is present within our Hawaiian People and Churches.

A handwritten signature in black ink, appearing to read "Bill Hā'ole". The signature is stylized with a large, sweeping initial "B" and a long, horizontal stroke extending to the right.

Me ke aloha a e ha'aha'a,

Bill Hā'ole, AHEC Luna Ho'omalu



MEMO:

TO: State Council of Hawaiian Congregational Churches Board of Directors
FROM: Toni Bissen, Executive Director
DATE: 4/17/18
RE: Pū'ā Foundation Annual Report

Aloha Kakou –

Lots of great things going on at the Pū'ā Foundation, mahalo for the opportunity to share, last time I submitted a report was at the last board meeting – 1/27/18. This report is being presented as a part of the Aha Iki annual meeting and will reflect information from June 2017 through May 2018.

2017 to 2018 – Summary for the Year/Recap:

- **Meetings Held & Attended** – 6/15/17, 7/22/17, 10/28/17, & 1/27/18
- **2017 & 2018 Plan – Pū'ā & SCHCC – Social Justice & Reconciliation work–Trauma, Healing, Justice**
 - **THE “WHAT”:**
 - **Offer Training on Trauma and Transformation** and the understanding of Individual, Community and Historical Trauma, and strategies of Recovery and Healing – for Individual Healing and Well-being and Community Healing and Well-being; Working toward reconciliation of the past to the present to build a better future for all of Hawaii.
 - **Develop partnerships** –
 - **Outreach and Networking**
 - **THE “HOW”:** See attached.

We are continuing to build community and form partnerships – public, private, faith-based organizations, justice involved peers, families, and supporters. Aspiration: Community Healing and Well-being; Individual Healing and Well-being. Actualize Aspiration: Going from Trauma to Transformation; Developing Resources to Meet the Need – through organizing, capacity building and training.

STRATEGIC PARTNERSHIPS & PROGRAM INNOVATION

PROGRAM / PROJECT CHART (P - I - T - L)

P = PREVENTION	I = INTERVENTION	T = TRANSITION	L = LEGACY
RIPEN - See Inside Panel	TICI, WCCC & FDC - See Inside Panel	OGH, Mercy House & Waimanalo	UA MAU KE EA - See Inside Panel

Going Home Consortium -
Community Organizing of:
Public, Private, Faith-based
Orgs, Families & Peers: Hawaii,
Oahu, Maui, Kauai

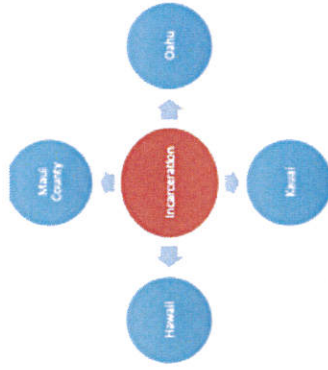

Mercy House - **Transitional Home**
for Women Exiting Prison



Waimanalo Project -
Farming, Structures,
Vocational Training



PŪ'Ā FOUNDATION
Empowering Individuals, Families & Communities

P.O. Box 11025, Hon., HI 96828
808-945-3570; www.puafoundation.org



T = To
R = Recover
A = And
U = Unleash
M = Magna O
A = Aloha

TRAUMA BASICS

6 - KEY PRINCIPLES

TRAUMA-INFORMED APPROACH

1. Safety
2. Trustworthiness and Transparency
3. Peer Support
4. Collaboration and Mutuality
5. Empowerment, Voice and Choice
6. Cultural, Historical, and Gender Issues

4 - DEFINITIONS - TRAUMA & RECOVER

1. Individual Trauma
2. Community Trauma
3. Historical Trauma
4. Recovery

TRANSFORMATION DIRECTION



WHO WE ARE

Pūā Foundation is a 501c3, Non-Profit Organization that was formed in 1996

- BORN out of an apology, redress & reconciliation initiative by the United Church of Christ in 1993 for their complicity in the 1893 overthrow of the Hawaiian Government.
- ESTABLISHED by this powerful act of reconciliation & justice addressing a historical traumatic event.
- SPECIALIZE: "Trauma to Transformation", which refers to trauma, healing, & justice, & the journey to healing, recovery & well being on an individual & community level.
- THRU advocacy, strategic partnerships & program innovation, we advance healing, justice & economic security for our service population.
- SERVE those affected by trauma & incarceration, especially women, girls & Native Hawaiian females, & their families.
- GROUND in ancient knowledge, we incorporate the PU'UHOUNA Model & Framework (*Criminal Justice System & Beyond Systemic Change & Collective Impact Community Building & Forming Partnerships*)

STRATEGIC PARTNERSHIPS & PROGRAM INNOVATION

PROGRAM / PROJECT CHART (P - I - T - L)

P = PREVENTION	I = INTERVENTION	T = TRANSITION	L = LEGACY
RIPEN - Peer Support Network & Mentoring	TICI, WCCC & FDC - Trauma Initiative / Community Programs	OGH, Mercy House & Waimanalo - See Back of Panels	UA MAU KE EA - Textbooks / DVDs, Film & Forum



RIPEN - REDUCING INTERGENERATIONAL POVERTY ELEVATING NEIGHBORHOODS

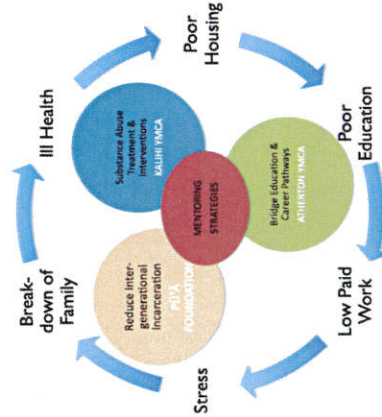

Trauma-Informed Care Initiative (TICI)
Creating a Place of Healing - Pu'uhonua
Pre Transition Course & Hawaiian Lecture Series

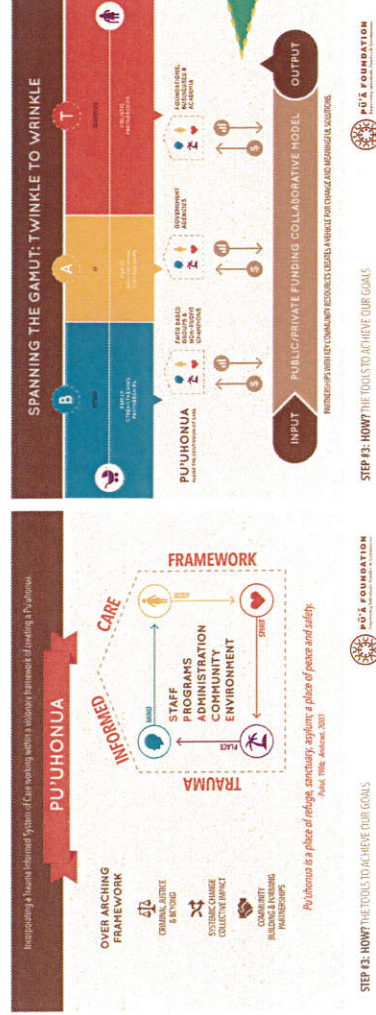

PAPA MAKUA
AHEC Annual 'Aha Nā kai 'Ewalu Report

Aloha nui kākou,

Ephesians 4:1-3 I therefore, a prisoner for the Lord, urge you to walk in a manner worthy of the calling to which you have been called, with all humility and gentleness, with patience, bearing with one another in love, eager to maintain the unity of the Spirit in the bond of peace.

As Papa Makua, I am called by Ke Akua to do the work of ministry among you. My call is to the pastoral kuleana and the life of each Kahu and each Kalawina church in our beloved association as well as all the other Kalawina churches through the Hawai'i Conference United Church of Christ.

May each of us in the churches, in the committees in the association, in the conference, and in the denomination, work for the sake of each one's worthy calling.

Iesū pū,

A handwritten signature in black ink, appearing to read 'Kenneth Makuakāne', with a stylized flourish at the end.

Kenneth Makuakāne
Papa Makua

Church Visits 2017 - 2018

- Kawaiaha'o Church, Ka'ahumanu Church, Olowalu Lanakila Church, Lili'uokalani Church, Keolahou Church, 'Ōla'a Church, 'Opihikao Church, Keolahou Church, Waiola Church, Kaulanapueo Church, Pā'ia First Hawaiian Church, Kalapana Maunakea Church, Haili Church, Kahikuonalani Church, Lanakila Church, Iao Congregational Church, Hau'oli Kamana'o Church
- Hōkūloa Church, Samoan Church of Hawai'i LMS, First United Protestant Church, Kailua Christian Church

AHEC Church News

- *Lili'uokalani*: Rev. Wally Kuroiwa is currently serving
- *Ka Hana O Ke Akua Church*: Using Supply Pastors for now.
- *Bishop Memorial Church*: Kahu Kordell Kekoa ended his chaplaincy July 31, 2017. Sherman Thompson has been the interim chaplain.
- *Kahikuonālani UCC*: There are now three churches worshipping in the sanctuary at different times. The two other churches are the Tuvalo For and the Pohnpeian church.
- *Kaumakapili Church*: The new senior pastor is Rev. Doug Wooten.
- *Kawaiaha'o Church*: Kahu Kenneth Makuakāne is the new senior pastor.
- *Keolahou Church*: Is in the interim minister search.
- *Kaulanapueo Church*: Called Kahu Jimmy Aarona to serve their church.

AHEC Churches without Kahu (15)

- Hau'ula Congregational Church, Ka Hana O Ke Akua Church, Lili'uokalani Protestant Church, Henry 'Ōpūkaha'ia/Hōkūloa Chapel, Laupāhoehoe Congregational Church, Puka'ana Congregational Church, Helani Church, Kalanikahua Hou Church, Keolahou Congregational Church, Lāhuiokalani Kā'anapali Congregational Church, Olowalu Lanakila Hawaiian Church, Waihe'e Protestant Church, Kalua'aha Congregational Church, Koolauhuiia Protestant Church

Association News

- Attended Kamehameha Schools Maui campus Founder's Day Celebration 12/20/2017
- Baby blessing at Olowalu Lanakila Church
- Hymn writing workshop at the O'ahu Clergy gathering in the conference ballroom
- Attended 'Ōla'a Church annual hō'ike September 16, 2017
- Attended 'Opihikao Church hō'ike November 11, 2017
- Attended Wānanalua Church Ali'i Sunday for Queen Ka'ahumanu 3/18/2018

- Attended Pā'ia First Hawaiian Church Ali'i Sunday for Prince Kūhiō 3/25/2018
- There were several passings of our kūpuna; Juliette Galuteria, Frank Masagatani - Kawaiaha'o Church, La'a Ham - Kalanikahua Hou Church, Kale Hanchett - Hau'ula Church, Nana Aiu - Ka Hana O Ke Akua Church

Hawai'i Conference News

- Rev. Dr. Iese Tuuao was Acting Conference Minister from July 5, 2017 to January 3, 2018.
- Intentional Interim Conference Minister Rev. Gabrielle Chavez began her ministry on January 3, 2018. Her term is through the 2019 'Aha Pae'āina.
- The Conference Council has hired independent consultant Cynthia Scherr to develop the new conference initiative through strategic meetings with a broad cross section of the conference. A working committee was selected to work with Ms. Scherr.
- The Regional Youth Event will be held in Honolulu June 25-29, 2018.

National Setting News

- Attended the 31st General Synod in Baltimore, Maryland June 30 - July 4, 2017.
 - Rev. Traci Blackmon overwhelmingly voted in to be the Minister of Justice & Witness
 - Affirming resolutions such as a) Calling for the UCC to advocate for the rights of children living under Israeli Military Occupation, b) On Corporal punishment of children in homes and institutions, c) Recognizing and studying gun violence as a public health emergency, d) Becoming an immigrant welcoming church, e) A more just economy: Living wages and Job creation, f) The Manual on Ministry revised, g) Enact minimum wage laws of \$15 per hour, h) Establishing procedures for cultural diversity training for authorized ministers, i). Resolution of witness in support of adult survivors of child abuse and neglect, j) Affirming and supporting the authorized ministries of under-represented clergy in local congregations, k) Resolution towards disability Justice, l) The earth is the Lord's - not ours to wreck; imperatives for a new era.
 - A polity class was held throughout the General Synod. It was so comprehensive that it makes the polity classes in Hawai'i feel like an elementary school education
 - Each plenary session was featured a keynote speaker that literally took your breath away, including Rev. Traci Blackmon, Glennon Doyle, Aaron Mair, PSR president Rev. David Vasquez-Levy, Rev. Kim Kendrick, and General Minister Rev. John Dorhauer.
 - Attended several events, including the Member in Discernment (MID) breakfast, the Church Vitality mixer for conference/denominational staff, synod committee sessions, the UCC Science and Technology networking, the Social Networking mixer, the Regional Theological Education Consortium luncheon

- Attended workshops that included a) Baltimore; life after Freddie Grey, b) a Virtual Reality online church of the UCC, c) the national Search and Call Fair
- Continue to serve on the national Regional Theological Education Consortium to develop multiple paths to ordination and authorized ministry work. Attended the gathering on April 30 - May 3, 2018 at Oberlin, Ohio.
- I sit on the UCC Council for Climate Justice. So far 25 of our 38 conferences are represented on this council.
- Attended the AM21 event in Denver, CO September 21-22 hosted by MESA to unfold the revised Manual on Ministry.
- Continue to be engaged in the UCC Communities of Practice for Associate Conference Ministers on a monthly basis.



STATE COUNCIL OF HAWAIIAN CONGREGATIONAL CHURCHES
P.O. BOX 407 HOLUALOA, HAWAII 96725

2018 Aha Iki of the 196th Aha Pae'aina
Community Church of Honolulu

SCHCC Annual Meeting
June 7, 2018

Aloha Kakou,

Another year has come and is almost ending, and as I reflect back over the past nine (9) plus months, I take this time to say “mahalo” to each of you for work “well done” as a member on the State Council of Hawaiian Congregational Churches (SCHCC) Board. The love, support, respect, and commitment you have shown, as representatives of your respective Island Councils and Partnership Ministries, counts heavily towards why our meetings have been as productive as they have. More importantly, your willingness to share with and listen to each other during our open discussions has been greatly appreciated.

I especially offer my “mahalo” for the aloha and support shown and shared during the Piko Ceremony honoring our former Conference Minister, Kahu Charles Buck, during the Aha Iki at the 195th Aha Pae'aina.

Other SCHCC matters of importance:

- 1) SCHCC has initiated a Conflict of Interest and Confidentiality Policy, which all Board members are required to read, understand, abide by and sign annually.
- 2) the Survey of Church Property forms has been re-circulated to all our Hawaiian churches. There has only been responses from 1/3 of our churches. All Hawaiian churches are encouraged to complete this form, so that we know how to help.
- 3) As custodians of the Katherine and Clay Wery Fund, the Executive Committee continues working on guidelines and procedures for this fund.
- 4) SCHCC is in the process of applying and filing for its own 501(c)(3) Non-profit status.
- 5) This is an election year. All positions are open. Anyone considering being nominated for any position is encouraged to read “Celebrating Advocacy: Past, Present & Future”, SCHCC's 60th Anniversary commemorative publication, to learn the history of the State Council of Hawaiian Congregational Churches.
- 6) The Repair & Maintenance Fund, a line item in the Hawaii Conference Foundation budget, remained at \$40,000.00 for FY 2017-2018. Four (4) churches received funding, totaling \$40,000.00.

The 2018 Aha Iki is being planned by four (4) Partnership Ministries; the Association of Hawaiian Evangelical Churches (AHEC), State Sunday School Association (SSSA), Christian Endeavor – Hawaii (CE-H), and the SCHCC. Sharon Matsuyama represents the SCHCC, as Chairperson, on the 2018 Aha Iki planning committee. Other committee members include representatives from AHEC, SSSA and CE-H.

Special mahalo to Kahikuonalani Church, in Pearl City, for graciously hosting our quarterly Board meetings for the past two (2) years. The SCHCC has, indeed, been blessed by your generosity. Mahalo also to the Maui Council, for hosting our two (2) days Board meeting on April 27 - 28, 2018.

As FY 2017–2018 comes to a close, the State Council of Hawaiian Congregational Churches will continue to be an advocate, to represent what will be in the best interest of our Hawaiian Churches of the Hawaii Conference United Church of Christ.

In His Service,
Boyd Matsuyama

Boyd Matsuyama
SCHCC President



*Hawaii Conference United Church of Christ
196th Aha Pae'aina*

*State Council of Hawaiian Congregational Churches
Aha Iki
June 07, 2018*

Advisor's Report

Aloha mai kakou,

It has been a privilege being a part of the SCHCC Board.

As this year comes to an end, I share again, my mahalo to all of you for allowing me to be a part of this wonderful organization.

As Advisor, it has been a pleasure working with each of you. The gift(s) and talent that each of you bring, to the SCHCC meetings, as representatives of your respective Island Councils and partnership ministries have been very important for this organization.

This year, 2018, marks the 70th Anniversary of the State Council of Hawaiian Congregational Churches. It was ten (10) years ago, in June 2008, that this organization had its first book published, "Celebrating Advocacy – Past, Present & Future". If "you" as a new member and even as a "long time" member of this Board have not read this book yet, the "advice" I share in my role as outgoing Advisor, is PLEASE READ THE BOOK.

This book, will help you understand better, the history of the State Council of Hawaiian Congregational Churches and its role as advocate of the Hawaiian Churches of the Hawaii Conference of the United Church of Christ. It will also help you understand how the State Council of Hawaiian Congregational Churches and the Association of Hawaiian Evangelical Churches can work "in unity" towards what would be in the best interest of all Hawaiian Churches.

To the SCHCC Board of Directors:

Officers – President, Boyd Matsuyama; Vice President, *Kahu Kealahou Alike; Secretary, Aletha Kaohi; Treasurer, Frank Mulec: **Resource Coordinator**, Stanley Lum: **Island Council Presidents / Representatives** – Kauai, Isaiah Kaauwai; Oahu, Ka'iulani Hess; Molokai, Uluwehi Sai; Maui, **Aileen Trout; East Maui, Nan Cabatbat; East Hawaii, Elouise Mulec; West Hawaii, Harry Aiu:

Partnerships – Association of Hawaiian Evangelical Churches, William Haole; Pu'a Foundation, Toni Bissen:

Committee Chairs - *Repair & Maintenance of Small Membership Hawaiian Churches;
**Kahu Richard W. Wong Endowment, mahalo for your desire to be mission driven and for your outstanding leadership representing the State Council of Hawaiian Congregational Churches.

It has, indeed, been my privilege serving as Advisor to this Council.

God's Blessings,

Sharon Matsuyama

Sharon Matsuyama

Advisor, SCHCC

Chairperson, William Kahuakai Keliihoomalu Scholarship Fund

cc: SCHCC Board of Directors

STATE COUNCIL OF HAWAIIAN CONGREGATIONAL CHURCHES

Board of Directors - Directory 2016-18

OFFICERS/ EXECUTIVE COMMITTEE

(as of July 01, 2016)

President - Boyd Matsuyama

Puka'ana Congregational Church (West Hawaii)

P.O. Box 228

Honaunau, Hawaii 96726

E-mail: yamabtm0@yahoo.com

Phone: 808-443-9433 (cell)

Vice-President - Kahu Kealahou Alike

Keawala'i Congregational Church (Maui)

5300 Makena Road

Makena, Hawaii 96753

E-mail: kahualika@hawaii.rr.com

Keawalai@hawaii.rr.com

Phone: 808-298-6527 (cell)

808-879-5557 (Office)

Secretary - Aletha G. Kaohi

Hanapepe Hawaiian Congregational Church (Kauai)

P.O. Box 109

Waimea, Hawaii 96796

E-mail: akaohi@kedb.com

agkaohi@hawaiiantel.net

Phone: 808-338-1447 (Home)

808-338-1332 (Office)

808-338-1925 (fax)

Treasurer - Frank J. Mulec

Opihikao Congregational Church (East Hawaii)

P.O. Box 1065

Pahoa, Hawaii 96778

E-mail: frankm808@yahoo.com

Phone: 808-982-5520

Advisor - Sharon Matsuyama

Pukaana Congregational Church (West Hawaii)

PO Box 228

Honaunau, Hawaii 96726

E-mail: keliipaakaua@gmail.com

Phone: 808-936-1385 (cell)

STATE COUNCIL OF HAWAIIAN CONGREGATIONAL CHURCHES
Board of Directors - Directory 2017-2018

**ISLAND COUNCIL REPRESENTATIVES / RESOURCE
CONFERENCE STAFF / PARTNERS**
(as of March 31, 2018)

Kaua'i

Isaiah Kaauwai - Vice President
Kapaa First Hawaiian Church
4-1325 Kuhio Hwy
Kapaa, Hawaii 96746
E-mail: ikaauwai@hotmail.com
Phone: 808-651-7205

O'ahu

Pauline Kaiulani Hess – President
Kawaiahao Church
957 Punchbowl Street
Honolulu, Hawaii 96813
E-mail: kaiulani.hess@att.net
Phone: 808-778-2059

Moloka'i

Pualani Akaka – President / Uluwehi Sai – Representative
PO Box 31
Kualapuu, Hawaii 96757
E-mail: pualani.akaka@gmail.com / uluwehisai@gmail.com
Phone: 808-213-5645 (Pualani) / 808-258-1891 (Uluwehi)

Maui

Aileen Trout – President
Lahuiokalani Kaanapali Congregational Church
1270 Nahale Place
Lahaina, Hawaii 96761
E-mail: atrout5525@aol.com
Phone: 808-661-9890 (home)
808-987-2536 (cell)

East Maui Hawaiian Ministry

Nan Cabatbat - President
110 Malanani Drive
Kula, Hawaii 96790
Phone: 808-878-6319 or
808-878-1420

East Hawai'i

Frank J. Mulec - President
Opihikao Congregational Church
P.O. Box 1065
Pahoa, Hawaii 96778
E-mail: frankm808@yahoo.com
Phone: 808-982-5520

West Hawai'i

Harry Aiu - President
Helani Congregational Church
P.O. Box 521
Kealahou, Hawaii 96750
E-mail: pualeimapu@hawaiiantel.net
Phone: 808-322-3510

Resource

Stanley H. L. Lum
46-251 Kapea Place
Kaneohe, Hawaii 96844
E-mail: hampton96744@yahoo.com
Phone: 808-235-1202 (home)
808-271-9152 (cell)

CONFERENCE STAFF

Interim Conference Minister - Kahu Gabrielle Chavez

Hawaii Conference United Church of Christ
1848 Nu'uuanu Avenue
Honolulu, Hawaii 96817
E-mail: gchavez@hcucc.org
Phone: 808-537-9516 (office)
1-800-734-7610 (toll free)

Papa Makua - Kahu Pono Kenneth Makuakane

Hawaii Conference United Church of Christ / AHEC
1848 Nu'uuanu Ave.
Honolulu, Hawaii 96817
E-mail: kmakuakane@hcucc.org
Phone: 808-537-9516 (office)
1-800-734-7610 (toll free)

PARTNERS

Pu`a Foundation

Toni Bissen – Executive Director

Pu`a Foundation

P.O. Box 11025

Honolulu, Hawaii 96828

E-mail: toni.bissen@puafoundation.net

Phone: 808-945-3570 (office)

808-221-6656 (mobile)

808-945-2203 (fax)

AHEC – Association of Hawaiian Evangelical Churches

William Haole – Luna Hoomalu

Association of Hawaiian Evangelical Churches

Hawaii Conference United Church of Christ

1848 Nuuanu Avenue

Honolulu, Hawaii 96817

E-mail: whaole54@gmail.com

Phone: 808-351-2149 (cell)

STATE COUNCIL OF HAWAIIAN CONGREGATIONAL CHURCHES

Member Churches

CHURCH / ADDRESS

COUNCIL

Haili Congregational Church,
211 Haili St., Hilo, Hawaii 96720-2928

East Hawaii

Kalapana Maunakea First Hawaiian Congregational Church
PO Box 20, Pāhoa, Hawaii 96778

East Hawaii

Laupahoehoe Congregational Church
74-229 Ililoa Street, Kailua-Kona, Hawaii 96740

East Hawaii

Ola'a First Hawaiian Church Congregational
PO Box 509, Kurtistown, Hawaii 96760-0509

East Hawaii

‘Opihikao Congregational Church
13-6325 Kalapana-Kapoho Beach Road, Pāhoa, Hawaii 96778-8084

East Hawaii

Pōhakupuka Congregational Church
PO Box 63, Ninole, Hawaii 96773

East Hawaii

Pu‘ula UCC
RR 4, Box 2258, Pāhoa, Hawaii 96778

East Hawaii

Hauoli Kamana‘o Church
79-7199 Mamalahoa Hwy #E138, Holualoa, Hawaii 96725

West Hawaii

Helani Congregational Church
PO Box 2509, Kealahou, Hawaii 96750

West Hawaii

Kahikolu Congregational Church
PO Box 1036, Captain Cook, Hawaii 96704

West Hawaii

Kauaha‘ao Congregational Church
PO Box 622, Nā‘ālehu, Hawaii 96772

West Hawaii

Lanakila Congregational Church
PO Box 1337, Kealahou, Hawaii 96750-1337

West Hawaii

Puka‘ana Congregational Church
PO Box 228, Hōnaunau, Hawaii 96726

West Hawaii

Bernice Pauahi Bishop Memorial Chapel
1887 Makuakāne St., Bldg. 65, Honolulu, HI 96817

Oahu

**State Council of Hawaiian Congregational Churches -
Member Churches**

Page 2 –

CHURCH / ADDRESS

COUNCIL

Hau‘ula Congregational Church
PO Box 480, Hau‘ula, Hawaii 96717

Oahu

Ka Hana O Ke Akua Church
PO Box 4026, Wai‘anae, Hawaii 96792

Oahu

Kahikuonalani Church UCC
757 Ho‘omalua St, Pearl City, Hawaii 96782

Oahu

Kalihi and Moanalua Church
1313 Kam IV Road, Honolulu, Hawaii 96819

Oahu

Kaumakapili Church
766 N. King St., Honolulu, Hawaii 96817

Oahu

Kawaiaha‘o Church
957 Punchbowl St., Honolulu, Hawaii 96813

Oahu

Lili‘uokalani Protestant Church
PO Box 187, Hale‘iwa, Hawaii 96812

Oahu

Wai‘anae Protestant Church
85-946 Mill St., Wai‘anae, Hawaii 96792

Oahu

Ka‘ahumanu Church
PO Box 1403, Wailuku, Hawaii 96793-6403

Maui

Kahakuloa Hawaiian Congregational Church
3499 Kahekili Hwy., Wailuku, Hawaii 96793

Maui

Keawala‘i Congregational Church
5300 Mākena Road, Mākena, Hawaii 96753

Maui

Keolahou Congregational Hawaiian Church
177 S. Kihei Road, Kihei, Hawaii 96753

Maui

Lahuioakalani Kā‘anapali Congregational Church
1270 Nahale Place, Lahaina, Hawaii 96761

Maui

**State Council of Hawaiian Congregational Churches -
Member Churches
Page 3 –**

CHURCH / ADDRESS

COUNCIL

Olowalu Lanakila Hawaiian Church
PO Box 2880, Wailuku, Hawaii 96793

Maui

Pā‘ia Hawaiian Protestant Church
PO Box 790540, Pā‘ia, Hawaii 96779

Maui

Waiola Church
PO Box 455, Lahaina, Hawaii 96767-0455

Maui

Kalanikahua Hou Church (Ha‘ikū Protestant)
PO Box 777, Ha‘ikū, Hawaii 96708

East Maui Hawn Ministry

Kaulanapueo Congregational Church
110 Malanani Dr., Kula, Hawaii 96790

East Maui Hawn Ministry

Keanae Congregational Church
HC-1, Box 64, Ha‘ikū, Hawaii 96708

East Maui Hawn Ministry

Nahiku Congregational Church
1107 L. Nahiku Road, Ha‘ikū, Hawaii 96708

East Maui Hawn Ministry

Wananalua Congregational Church
PO Box 188, Hana, Hawaii 96713

East Maui Hawn Ministry

Hanapēpē Hawaiian Congregational Church
PO Box 428, Hanapēpē, Hawaii 96716

Kauai

Kapa‘a First Hawaiian Church
4-1325 Kūhiō Hwy, Kapa‘a, Hawaii 96746

Kauai

Ko‘olau Hui‘ia Protestant Church
PO Box 252, Anahola, Hawaii 96703

Kauai

‘Ohana Ni‘ihau O Waimea
PO Box 273, Makaweli, HI 96769

Kauai

Waimea UCC
PO Box 457, Waimea, HI 96796

Kauai

**State Council of Hawaiian Congregational Churches -
Member Churches
Page 4 –**

CHURCH / ADDRESS

COUNCIL

Wai‘oli Hui‘ia Church
PO Box 231, Hanalei, HI 96714

Kauai

Ho‘olehua Congregational Church
PO Box 196, Ho‘olehua, HI 96729

Molokai

Kalaiakamanu Hou Congregational Church
PO Box 606, Kaunakakai, HI 96748

Molokai

Kalua‘aha Congregational Church
PO Box 405, Kaunakakai, HI 96748

Molokai

Kana‘ana Hou-Siloama UCC
PO Box 100, Kalaupapa, HI 96742

Molokai

Waialua Congregational Church
10417 Kamehameha V Hwy, Kaunakakai, HI 96748

Molokai

STATE COUNCIL OF HAWAIIAN CONGREGATIONAL CHURCHES
NEW MEMBERSHIP PROCEDURES

New churches will be formed from time to time, desiring to be *considered for and accepted as* a member of the State Council of Hawaiian Congregational Churches.

The responsibility of recognizing new churches, into the State Council of Hawaiian Congregational Churches, is that of the Island Council.

Pre-requisite for Membership:

- 1) The New Church must be a member of an Association of the Hawaii Conference of the United Church of Christ (*i.e. Kauai, Oahu, Tri-Isle (Maui, Moloka'i, Lana'i), Hawai'i or AHEC*) who/which embraces Hawaiian cultural practices, including its language, its values and its traditions.
- 2) The New Church shall present a letter seeking membership and its church bylaws to the Island Council within whose bounds it is located.
- 3) An Island Council, having received such a letter and bylaws, from the New Church, shall inquire as to its understanding of the United Church of Christ Polity.
Membership requires commitment to attend and be an active participant at all Island Council Meetings and events, as well as be up-to-date with the payment of membership dues as required.
- 4) Upon reviewing the required documents and insuring that the New Church candidate understands and is in agreement with the United Church of Christ Polity, the Island Council shall present its recommendation to the State Council of Hawaiian Congregational Churches Board of Directors.
- 5) The State Council of Hawaiian Congregational Churches having received the recommendation of the Island Council shall, at its discretion, vote on membership.
- 6) Upon acceptance, the State Council of Hawaiian Congregational Churches shall conduct a Service of Covenant at its Annual Meeting (the Aha Iki) during the Aha Pae'aina.

Note: *If a New Church candidate is not a member of an Association of the Hawaii Conference of the United Church of Christ (i.e. Kauai, Oahu, Tri-Isle (Maui, Moloka'i, Lana'i), Hawai'i or AHEC) but embraces Hawaiian cultural practices, including its language, its values and its traditions, the Island Council may consider Associate Membership status (as outlined in 2, 3, 4 and 5).*

(Accepted / approved 8/2015)

THE CONSTITUTION
of the
STATE COUNCIL OF HAWAIIAN CONGREGATIONAL CHURCHES
(Affiliate Organization of the Hawai‘i Conference of the United Church of Christ)

PREAMBLE

The State Council of Hawaiian Congregational Churches celebrates and nourishes its biblical roots in the Christian faith, while sustaining the richness of Hawaiian traditions and cultural values. The State Council of Hawaiian Congregational Churches draws together Churches which strive to create opportunities for spiritual growth, leadership and commitment in order to attain a common vision. This vision embraces the nurturing of all people to become instruments for building a better world and community.

ARTICLE I: NAME

This Council shall be known as the State Council of Hawaiian Congregational Churches (hereinafter referred to as the SCHCC), an affiliate organization of the Hawai‘i Conference of the United Church of Christ (hereinafter referred to as the HCUCC).

ARTICLE II: PURPOSE

To advocate at all levels of the Hawai‘i Conference of the United Church of Christ in the best interest of the Hawaiian churches.

ARTICLE III: POLITY

The SCHCC is a voting member of the HCUCC, as described in the Charter and Bylaws of that organization.

The governance of the SCHCC is vested in its member churches, who shall exercise the right of control in all its affairs subject to the laws of the State of Hawai‘i.

ARTICLE IV: MEMBERSHIP

Section 1. Members

1. Member churches of the SCHCC; Island Councils, within the HCUCC.
2. Member churches embracing Hawaiian cultural practices, including its language, its values and its traditions.
3. Member churches shall have a voice in the affairs of the SCHCC and the right to vote as provided in its Bylaws.

Section 2. Delegates

1. An active member church shall be entitled to one lay delegate. Churches having more than 200 members shall be entitled to elect one additional lay delegate for each additional 100 members, up to a total of five delegates.
2. Each active member church shall also be entitled to elect one youth / young adult delegate, twenty five years of age or younger.
3. One authorized minister (ordained, licensed or commissioned) from each active member church.

Section 3. Annual Dues

An active member church is one which is current in payment of their assessed dues. Each member church shall be assessed annual dues. Dues shall be paid and recorded by the Treasurer by January 31.

ARTICLE V: BOARD OF DIRECTORS

The management of the business and affairs of the SCHCC shall be the responsibility of the Board of Directors, which shall consist of the Officers of the SCHCC, one (1) representative from each of the Island Councils and one (1) representative from each Partnership Ministry; such number of directors as outlined in the Bylaws of the SCHCC but under no circumstances less than five (5). Subject to such limit, the member churches may increase or decrease the number of Directors at an Annual Meeting. In the event the Board membership falls below the minimum of five (5), the SCHCC Board of Directors shall make interim appointments for the unexpired term(s).

The Directors shall be qualified, nominated, elected, and appointed as provided in the Bylaws. Each Director of the SCHCC shall serve until his or her successor is duly elected.

Section 1. Officers

The Officers of the SCHCC shall be a President, a Vice President, a Secretary, a Treasurer and an Advisor, all of whom shall be members in good standing in an active member church of the SCHCC and with such qualifications, duties and powers as may be provided for in its Bylaws. Except for the Advisor, Officers shall be elected at the Annual Meeting during the 'Aha Iki, or as otherwise provided in Article V above, and preferably with no more than two of the four officers from the same island. The Advisor shall be appointed by the President.

Section 2. Island Councils

There shall be one representative from each of the following Island Councils: Kaua'i, O'ahu, Moloka'i, East Hawai'i, West Hawai'i, Maui, and East Maui Hawaiian Ministry.

Section 3. Partnership

One representative from the Association of Hawaiian Evangelical Churches shall have the privilege of voice and vote.

Any other partnership shall have the privilege of voice only without vote.

ARTICLE VI: AMENDMENTS

This Constitution may be amended by two-thirds (2/3) vote of the delegates of member churches present at the Annual Meeting, provided notices of the proposed amendment(s) shall have been given to each member church at least 30 days prior to the Annual Meeting where voting will take place.

(Constitution amended June 10, 2015)

BYLAWS

of the

STATE COUNCIL OF HAWAIIAN CONGREGATIONAL CHURCHES
(Affiliate Organization of the Hawai'i Conference of the United Church of Christ)

ARTICLE I: MEMBERSHIP

Section 1. Members

1. Member churches of the State Council of Hawaiian Congregational Churches (hereinafter referred to as the SCHCC), Island Councils, within the Hawai'i Conference of the United Church of Christ (hereinafter referred to as the HCUCC).
2. Member churches embracing Hawaiian cultural practices, including its language, its values and its traditions.
3. Member churches shall have a voice in the affairs of the SCHCC and the right to vote as provided in Article I; Section 5. Voting Privileges of these Bylaws.

Section 2. Partnerships

1. One representative from the Association of Hawaiian Evangelical Churches shall have the privilege of voice and vote.
2. One representative from Pū'ā Foundation shall have the privilege of voice only without vote.

Section 3. Delegates

1. An active member church shall be entitled to one lay delegate. Churches having more than 200 members shall be entitled to elect one additional lay delegate for each additional 100 members, up to a total of five delegates.
2. Each active member church shall also be entitled to elect one youth / young adult delegate, twenty five years of age or younger.
3. One authorized minister (ordained, licensed or commissioned) from each active member church.

Section 4. Annual Dues

An active member church is one which is current in payment of their assessed dues. Each member church shall be assessed annual dues as recommended by the Board of Directors and approved at the Annual Meeting. Dues shall be paid and recorded by the Treasurer by January 31. In addition, each member church is required to be in good standing with their respective Island Councils.

Section 5. Voting Privileges

Each member church, lay delegate, youth/young adult delegate and minister as outlined in Article 1, Sections 1 & 2 of these Bylaws shall have voice only in the affairs at the Quarterly Board of Directors (BOD) meeting, and voice with vote at the Annual Meeting.

1. An active member church shall be entitled to one voting delegate. Churches having more than 200 members shall be entitled to one additional voting delegate for each additional 100 members, up to a total of five voting delegates.
2. Each active member church shall be entitled to a youth/young adult voting delegate.
3. One authorized minister from each active member church shall be entitled to a vote.
4. SCHCC Officers (Vice President, Secretary, Treasurer and Advisor) and BOD members shall have voting privileges at the quarterly Board of Directors meetings, Special meetings and Annual Meeting.
5. SCHCC President shall have voting privileges at the quarterly Board of Directors meetings, Special meetings and Annual Meeting, only in the event of a tie.

ARTICLE II: BOARD OF DIRECTORS

Section 1. Composition of the Board of Directors -

There shall be a Board of Directors consisting of the following:

1. The Officers of SCHCC (President, Vice President, Secretary, Treasurer and Advisor);
2. One (1) representative from each of the Island Councils (Kaua'i, O'ahu, Moloka'i, East Hawai'i, West Hawai'i, Maui, and East Maui Hawaiian Ministry);
3. One (1) representative from the Partnership Ministries (AHEC and Pū'ā Foundation).

Section 2. The purpose of the Board of Directors is to advocate, in the best interest of the Hawaiian churches, at all levels of the HCUCC.

Section 3. Tenure - Each SCHCC Officer shall serve for a term of two (2) years. Each Island Council representative and Partnership Ministry representative shall serve their terms as allowed by their respective bylaws.

ARTICLE III: OFFICERS

The Officers shall be members in good standing within an active member church of the SCHCC. There shall be a President, a Vice President, a Secretary, a Treasurer and an Advisor. The duties of the Officers shall be as follows:

Section 1. President:

1. Shall preside at all meetings of the SCHCC Board of Directors and the Executive Committee.
2. Shall be responsible for the administration of business affairs.
3. Shall prepare an Annual Report
4. May create and appoint Task Forces and Special Committees as needed, with the Board of Directors approval.
5. Shall be an ex-officio member of all Standing Committees, except the Nominations Committee, with voice only and no vote.
6. Shall represent the SCHCC on the HCUCC Council.

Section 2. Vice President:

1. Shall be the presiding officer in the absence of the President.
2. Shall assume the presidency in the event the President resigns or is not able to serve.
3. Shall chair the Committee for Repair and Maintenance of Small Membership Hawaiian Churches.
4. Shall prepare an Annual Report of the Committee for Repair and Maintenance of Small Membership Hawaiian Churches.

Section 3. Secretary:

1. Shall record accurate minutes of all meetings of the Board of Directors and the Executive Committee, including Special meetings pertaining to the business of SCHCC, as well as the Annual meeting.
2. Shall be responsible for compiling and preparing reports submitted by all Officers, the Advisor, Island Council Presidents, Committee Chairs and Partnership Ministries for the Annual Meeting handbook.
3. Shall provide a sign-in sheet for all meetings of the Board of Directors and the Executive Committee as well as for all delegates attending the Annual Meeting.
4. Shall include a copy of the previous year's Annual Meeting minutes in the current year Annual Meeting handbook.

5. Shall send Board of Directors and Special Meeting minutes to the members of the Board of Directors, 2 weeks prior to each scheduled Board meeting, with the agenda for the scheduled meeting.
6. Shall send Executive Committee meeting minutes to the Executive Committee, 2 weeks after the meeting.
7. Shall record any corrections and additions to all meeting minutes, after approval by the Board.
8. Shall issue notices of meetings one (1) month prior to each meeting by written notice, via email. (If no email access, then by U.S. Mail)

Section 4. Treasurer:

1. Shall receive and deposit all funds in an accredited financial institution approved by the Board of Directors of this Council.
2. Shall keep an accurate accounting of all funds received and disbursed and shall give a detailed report of all accounts at each Board of Directors meeting.
3. Shall prepare a financial report for the Annual Meeting.
4. Shall keep an accurate record of all member churches current with payment of their dues and notify the Secretary of those member churches in arrears by March 01 of each year prior to the Annual Meeting.
5. Shall make all payments by check. There shall be two signatures on the checks, those of the Treasurer and the President or Secretary.

Section 5. Advisor:

1. Shall have thorough understanding and experience of the SCHCC.
2. Shall advise the Board of Directors in matters of function, policy, church polity, past practices and historical background.
3. Shall prepare a report for each board meeting and the Annual Meeting.
4. Shall be appointed by the President and shall serve a term coincident with the President's.

ARTICLE IV: TERM OF OFFICE

The officers of the SCHCC shall be elected for a term of two (2) years. They may not serve in the same office for more than two (2) consecutive terms.

The President shall have the authority, with approval by the Board of Directors, to fill any vacancy in the officer positions for an interim period until the next scheduled election.

ARTICLE V: REMOVAL OF OFFICER

Any officer may be removed by a majority vote of the membership whenever the best interest of the Hawaiian Churches and this Council is not served. - 7 -

ARTICLE VI: EXECUTIVE COMMITTEE

Section 1.

The Executive Committee shall be comprised of the Officers of the SCHCC. The Executive Committee is charged with the following responsibilities:

1. Prepare the agenda for all meetings
2. Establish the date and time of all meetings
3. Be an advocate for all member churches
4. Prepare the Annual Budget

ARTICLE VII: MEETINGS

All meetings shall be opened and closed with pule 'ohana.

Section 1. Annual Meeting

The Annual Meeting will be held during the 'Aha Iki at the 'Aha Pae'aina in June. During the Annual Meeting of the SCHCC, time shall be provided for business, spiritual and cultural awareness concerns.

The majority vote shall be the preferred method for deciding matters that are before the member churches at the Annual Meeting.

Section 2. Board of Directors Meetings Schedule

The SCHCC Board of Directors shall meet in July, October, January and April. All Board of Directors meetings are open to member churches, with the privilege of voice only, without vote.

Section 3. Special Meetings

Special meetings may be called by the Board of Directors, by written notice sent out electronically or by U.S. Mail fourteen (14) days in advance to active member churches, stating time, place and purpose of the special meeting.

ARTICLE VIII: STANDING COMMITTEES

Section 1. Standing Committees

The Standing Committees shall be: (1) Repair and Maintenance of Small Membership Hawaiian Churches. (2) Endowment / Scholarship.

The Committee chairpersons shall be members of the Board of Directors and will be appointed by the Board of Directors. The Chairperson of the Committee for Repair and Maintenance of Small Membership Hawaiian Churches, shall be the Vice President.

The Chairperson of the Endowment / Scholarship Standing Committee will maintain the autonomy of the independently funded programs reporting through the SCHCC.

(Endowment / Scholarship Standing Committees may include Kahu Richard Wong Endowment Fund, William Keliihoomalu Scholarship and others).

Section 2. Task Forces and Special Committees:

The President may establish Task Forces and Special Committees to address special issues and needs with majority approval votes from the Board of Directors.

ARTICLE IX: INDEMNIFICATION AND INSURANCE

Section 1.

The SCHCC shall indemnify each person who was or is a party or is threatened to be made a party to any threatened, pending or completed action, suit or proceeding, whether civil, criminal, administrative, or investigative (other than an action by or in the right of the SCHCC) if that person is or was a director, officer or agent (hereinafter to include volunteers) of the SCHCC, against expenses (including attorneys' fees), judgments, fines, settlements, and other amounts actually and reasonably incurred in connection with the proceeding if the person acted in good faith and in a matter the person reasonably believed to be in or not opposed to the best interests of the SCHCC, and, with respect to any criminal proceedings, had no reasonable cause to believe the conduct of the person was unlawful. The termination of any proceedings by judgment, order, settlement, conviction or upon plea of nolo contendere or its equivalent, shall not, of itself, create a presumption that the person did not act in good faith and in a manner which the person reasonably believed to be in or not opposed to the best interests of the SCHCC and, with respect to any criminal action or proceeding, had reasonable cause to believe that other person's conduct was unlawful.

Section 2.

The SCHCC shall indemnify each person who was or is party or is to be made a party to any threatened, pending or completed action or suit in the right of the SCHCC to procure a judgment in its favor because that person is or was a director, officer, or agent of the SCHCC against expenses (including attorney's fees) actually and reasonably incurred by the person in connection with the defense of settlement of the action if the person acted in good faith and in a matter the person reasonably believed to be in or not opposed to the best interest of the SCHCC, except that no indemnification shall be made in respect of any claim, issue, or matter as to which the person shall have been adjudged to be liable for negligence or misconduct in the performance of the person's duty to the SCHCC unless and only to the extent that the court in which the action or suit was brought shall determine upon application that, despite the adjudication of liability but in view of all the circumstances of the case, the person is fairly and reasonably entitled to indemnity for such expenses as the court deems proper.

Section 3.

To the extent that a director, officer, or agent of the SCHCC has been successful on the merits or otherwise in defending any proceeding referred to in Sections 1 or 2 of this Article, or in defense of any claim, issue or matter therein, such person shall be indemnified by the SCHCC against expenses (including attorney's fees) actually and reasonably incurred by such person in connection therewith.

Section 4.

Any indemnification under Sections 1 and 2 of this Article (unless ordered by a Court) shall be made by the SCHCC only if authorized in the specific case upon determination that indemnification of the director, officer or agent is proper in the circumstances because the director, officer, or agent has met the applicable standard of conduct set forth in Sections 1 or 2.. The determination shall be made (a) by the Board of Directors by a majority vote of quorum consisting of directors who were not parties to the proceeding, or (b) if a quorum is not obtainable, or even, if obtainable if a quorum of disinterested directors so directs, by the independent legal counsel in a written opinion to the SCHCC or (c) by the court in which the proceeding is or was pending upon application made by the SCHCC or the director, officer, or agent or the attorney or other person rendering services in connection with the defense, whether or not the application by the director, officer, agent, attorney or other person opposed by the SCHCC.

Section 5.

Expenses incurred in defending any proceeding may be paid by the SCHCC in advance of the final disposition of the proceeding as authorized by the Board of Directors in a particular case upon receipt of an undertaking by or on behalf of the director, officer, or agent to repay such amount unless it shall ultimately be determined that the director, officer or agent entitled to be indemnified by the SCHCC as authorized in this article.

Section 6.

The indemnification provided by this Article shall not be deemed exclusive of any other rights to which those indemnified may be entitled and shall continue as to a person who has ceased to be a director, officer, or agent and shall insure to the benefit of the heirs and personal representatives of such a person.

Section 7.

The SCHCC shall have the power to purchase and maintain insurance on behalf of any director, officer, or agent of the SCHCC against any liability asserted against or incurred by the director, officer, or agent in any such capacity or arising out of the director's, officer's or agent's status as such, whether or not the SCHCC would have the power to indemnify the director, officer, or agent against liability under this Article.

ARTICLE X: QUORUM

Section 1. Annual Meeting

The Quorum for the Annual Meeting shall consist of a majority of active member churches present.

Section 2. Board of Directors

The presence of two-thirds (2/3) of the Board of Directors will constitute a quorum.

ARTICLE XI: PARLIAMENTARY PROCEDURES

When questions of Parliamentary Procedures are raised, particularly on issues that are contested, the current edition of Robert's Rules of Order shall be consulted to resolve any impasse.

ARTICLE XII: AMENDMENTS

These Bylaws may be amended by two-thirds (2/3) vote of the delegates of member churches at the Annual Meeting, provided notices of the proposed amendment(s) shall have been given to each member church at least 30 days prior to the Annual Meeting where voting will take place.

(Bylaws amended June 10, 2015)

OUR KULEANA

The overarching role of the State Council of Hawaiian Congregational Churches is to promote the viability of Hawaiian churches in ways & matters that will enable them to live, develop, thrive, & grow.

We go about this role ever mindful of *Queen Lili'uokalani's* parting words when she spoke of the loss of the Kingdom. She said that earthly kingdoms can be lost by inflexibility, intolerance & prejudice, as well as by being too flexible, tolerant of too many wrongs, & without judgment at all. State Council looks constantly to the path that lies between these extremes.

While one cannot turn back the time of political change, the Queen believed there was still time to save our heritage, but we must never cease to act for fear of failure. It was that heritage that allowed Christianity to flourish in Hawai'i. It is that heritage which State Council honors.

Our earthly kingdom is the Kingdom of God, here and now, in our time. It embraces not just our faith, but the faiths of all denominations; it embraces not just our congregation, but the congregations of all churches organized in the tradition of the Congregational faith. Thus, respecting the devotion and commitment of *na kupuna* to the Christian faith and their churches, and keeping foremost in mind the Queen's words, specific aspects of our overarching role are:

On nourishing our Christian faith and our spiritual growth:

1) To convey, at every opportunity, an abiding sense of covenantal relationships in ministries and interacting with other churches, the Conference, and the National Church. These relationships form the basis for our faith journey with God. They are the backbone of our faith, our *mana o 'i'o*. They are the promises we make as God-loving people to Creator, Church, community, and ourselves.

2) To encourage and promote participation in Our Church's Wider Mission (OCWM) ministry.

3) To foster and encourage active participation on mission teams and governing bodies of the HCUCC.

- 4) To assist churches in obtaining information on resources to improve and broaden their missions.
- 5) To foster and encourage attendance at General Synod

On sustaining the richness of Hawaiian traditions and cultural values.

- 1) To foster and encourage participation in the *Aha Pae'aina* by helping to develop agenda that incorporate cultural values & tradition & opportunities for fellowship.
- 2) To foster greater understanding of Hawaiian values, traditions, customs & their relevance in our Christian faith.

On leadership & ministries in Hawaiian churches.

- 1) To foster, encourage, and promote leadership training in Hawaiian churches.
- 2) To administer Rev Richard Wong & William Keli'ihoomalu Trust funds entrusted to SCHCC
- 3) To assist churches in establishing and maintaining Church Profiles
- 4) To collect & circulate information regarding ministries of Hawaiian churches, their results & impact

On Drawing Hawaiian Churches together

- 1) To promote interaction and exchange among all churches.
- 2) To serve as a channel of communication to the Conference on concerns, questions, and needs of Hawaiian churches.
- 3) To serve as a catalyst for beneficial change that could affect all Hawaiian churches.

On keeping safe and well our Hawaiian Places of Worship.

- 1) To administer funds entrusted to SCHCC for maintenance and repair of small Hawaiian churches.
- 2) To provide input to the Conference Foundation on the level of funding needed to maintain and repair small Hawaiian churches.

On Healing the Hawaiian Soul.

- 1) To actively participate with other organizations in promoting understanding in a process of reconciliation within the Hawaiian community and churches of the HCUCC.



Founded 1948

An affiliate organization
of the United Church of Christ,
Hawai'i Conference

**We advocate on behalf
of member
Hawaiian Churches**

WHO WE ARE

The State Council of Hawaiian Congregational Churches (the "State Council") is an affiliate organization of the Hawai'i Conference of the United Church (the "HCUCC" or the "Conference"). It is part of the Conference Council with both voice and vote but receives no operating funds from the HCUC.

The State Council was initially formed in 1948 as a loosely knit federation of Hawaiian churches that traced their historical roots to the American missionary work that began in 1820. Their purpose was to draw attention to their needs and concerns amidst growing feelings of alienation. Hawaiians saw their interests fall by the wayside as the Congregational faith in Hawai'i grew in size and complexity while the congregations of *Kalawina* churches - so called to reflect the Calvinist theology brought by the missionaries - fell ever smaller in number and impact. Hawaiian was the host culture; their churches the forerunner of Christian faiths in the islands. On their cornerstones all subsequent congregations were built.

In 1948, a coalition of Hawaiian churches successfully introduced a resolution at the *Aha Pae 'aina* that set aside time on the agenda for *Kalawina* churches to have meetings of their own at which they could voice their *mana'o*. In 1952, this coalition was formally organized as the Council of Hawaiian Churches to provide leadership for *Kalawina* churches, promote their work, and maintain their great interest in fellowship. Several years later, the Council was re-named the State Council of Hawaiian Congregational Churches. Its' founding purposes continue today.

SOME HISTORICAL NOTES

Over the course of time and history, membership in Hawaiian churches began falling for several reasons: the depopulation of Hawaiians from introduced diseases; the rapid commercial growth of Hawai'i in the 1870's; heated political disturbances; and the influx of immigrant labor. By 1900, *Kalawina* churches lost 15,000 members; by 1965 they were down to 2,536 and in danger of falling even further.

The firm of Kramer, Miller & Associates was hired to review the entire conference of UCC churches, to include the unique concerns of the *Kalawina* churches. Its' subsequent report in 1968, confirmed that Hawaiian churches were on the verge of disappearing if not given consideration and assistance. Impelled by that finding, a Hawaiian Ministry Program, in coordination with the State Council, was established to assist Hawaiian churches toward self awareness and active participation in the total ministry of the HCUC.

The Hawaiian Ministry Program ended in 1992 as the Conference re-shaped itself. In that process Hawaiian culture was acknowledged and confirmed as the host culture for the Congregational Church in Hawai'i and the State Council was recognized as advocate for Hawaiian churches. SCHCC serves as a constant reminder of the Hawaiian presence that first embraced and nurtured the Christian faith in these islands.



60th Anniversary Commemorative Publication of the State Council of Hawaiian Congregational Churches 1948 to 2008

OUR MISSION/VISION

Our Mission is to advocate, at all levels, on behalf of all Hawaiian churches holding membership in the Hawai'i Conference of the United Church of Christ.

Our Statement of Vision is found in the Preamble to our Constitution:

"The State Council of Hawaiian Congregational Churches celebrates and nourishes its biblical roots in the Christian faith, while sustaining the richness of Hawaiian traditions and cultural values. The State Council of Hawaiian Congregational Churches draws together Churches which strive to create opportunities for spiritual growth, leadership and commitment in order to attain a common vision. This vision embraces the nurturing of all people to become instruments for building a better world and community."

We embrace and cherish our Christian faith as we respect our cultural heritage and ultimately seek the peace that comes with living comfortably in both.

STATE COUNCIL OF HAWAIIAN CONGREGATIONAL CHURCHES

Primary Business Address
Your Address Line 2
Your Address Line 3
Your Address Line 4
Phone: 555-555-5555
Fax: 555-555-5555
E-mail: someone@example.com

**STATE COUNCIL OF HAWAIIAN CONGREGATIONAL CHURCHES
(SCHCC)**

**FUND FOR REPAIR & MAINTENANCE OF
SMALL MEMBERSHIP HAWAIIAN CHURCHES**

Application Information

Funding for the Repair & Maintenance of Small Membership Hawaiian Churches is included by the Hawaii Conference Foundation (HCF) in its annual budget. Monies so allocated must be spent within the fiscal year for which it is approved.

The SCHCC has been given the responsibility for administering the funds, but in truth, we must all be partners in seeking the means by which needed repairs can be made. The underlying philosophy of the HCF and SCHCC is to help Hawaiian churches help themselves by sharing in the efforts by church members to raise funds (*i.e.* fundraising, solicitation of gifts, tithing goals, etc.)

More often than not, requests from Hawaiian churches exceed the amount allocated in the budget, not surprisingly, given the age of some of the structures and facilities. The task of reviewing requests and determining which are funded and by what amount, falls to the SCHCC.

In so doing the SCHCC Committee for the Repair & Maintenance of Small Membership Hawaiian Churches (hereinafter referred to as R&M Committee) must take into account a number of considerations including the following:

- The Need for the Project

Is the repair or maintenance critical? How would it affect the mission of the church? What might happen if it were not done? Is it time-critical? Must the work be done within a certain time-frame? What is the church's participation (*i.e.* sharing the cost; providing in-kind services; a combination of both?)

- Priority Consideration

If there are not enough funds to grant all requests, support must first be given to the churches whose deed is held by the HCF. The HCF, as Trustee, has a fiduciary responsibility which carries a legal obligation to support those churches.

In cases where a church that holds its own deed is faced with unusual extenuating circumstances that cannot be addressed because of the preferential obligation imposed by the Trust, SCHCC may suggest an alternative that avoids any conflict.

Applications for the repair and maintenance of septic systems and handicapped accessibility are also priorities of the fund. The first would be in compliance with the Environmental Protection Agency (EPA) and the State Department of Health.

The second would be in compliance with the Americans With Disabilities Act (ADA).

- Scope of Work

The fund is available to cover the cost of the repair and maintenance to existing structures on church premises including the *hale pule* (church building), *hale 'āina* (social/fellowship hall) and *hale ke 'ena* (office building). The scope of work may include the repair and maintenance of windows, doors, floors, and roofs as well as painting, electrical, plumbing and fumigation work.

What the fund does not cover is the cost for sound systems, computer systems, carpeting, air conditioning, fans, appliances and furnishings as well as parking lots, landscaping, gates and fences.

- Reimbursements

Reimbursements for complete projects will not be considered unless, at the discretion of the R&M Committee, compelling and justifiable reasons dictate otherwise.

- Completeness of Application

All applicable items must be completed including the duly-signed minutes of the meetings of both the Member Church and its respective Island Council. The minutes of the meeting of the church's governing body (*i.e.* Congregation, Church Council) must include the type of project the funds are being requested for; the estimated cost of materials, labor and skills to be hired; a clear showing of the total amount to be contributed by the Member Church in cash, in-kind services, or a combination of both and the action taken.

Projects costing more than \$5,000 must be supported by a Licensed Contractor's estimate.

- Discerning Need

Member Churches are encouraged to discern what is needed most. The work of reviewing and acting upon requests for assistance presents the SCHCC, through the work of the R&M Committee, with a challenge and an opportunity to be in partnership with our member churches.

There are no hard and fast rules. There is no checklist.

However, there are guidelines governing the work of the R&M Committee. The R&M Committee seeks to do its work prayerfully and thoughtfully relying upon the Holy Spirit for wisdom and guidance.

Reviewing the Application

1. Member Church forwards the completed Application Form, with the minutes of the meeting of the church's governing body (*i.e.* Congregation, Church Council) approving the submission of the application to the Island Council President.

Please provide the original application plus 2 additional sets of the application (single-sided copies only) and minutes (double-sided recommended).

2. Upon approval by its Island Council, the Island Council President will forward the application form of the Member Church to the Chairperson of the R&M Committee. The Island Council will provide the minutes of the meeting approving the submission of the application to the R&M Committee.

All applications are due by December 31st.

1. At the first scheduled meeting of the SCHCC Board of Directors following the December 31st deadline, the R&M Committee shall present its recommendation to the Board.

Whether an application is approved or denied, the Chairperson of the R&M Committee will inform the Member Church of the Board's decision by written notice or via email.

4. Upon approval by the SCHCC Board of Directors, the Chairperson of the R&M Committee shall inform the Executive Director of the HCF, in writing, of the name of the church and the amount of the approved grants. The Chairperson of the R&M Committee shall provide the HCF with the approved applications and the minutes of the SCHCC Board of Director's meeting in which the approval action was taken.
5. Upon completion of its project, the Member Church shall submit a written report to the R&M Committee, preferably with photographs if available. At that time the account will be closed.
6. Any unused funds shall be returned to the SCHCC. Unused funds may not be applied to other projects.

If new projects are considered, churches must submit a new application.

(Revised: October 2016)

**STATE COUNCIL OF HAWAIIAN CONGREGATIONAL CHURCHES
(SCHCC)**

**FUND FOR REPAIR & MAINTENANCE OF
SMALL MEMBERSHIP HAWAIIAN CHURCHES**

Application Form

Please complete sections A & B Only

A. Contact Information & Project Proposal

1. Name of Church: _____

Church Address: _____

Mailing Address: _____

Street or P.O. Box City/State Zip Code

Telephone Number: _____ Email: _____

Contact Person: _____

Telephone Number: _____ Cell Phone Number: _____

Email: _____ Additional Contact Information: _____

2. Does the Hawaii Conference Foundation hold the church's title or deed?

___ Yes ___ No

3. Project Proposal: *(If necessary, use a separate sheet of paper and attach to this application)*

- What is to be done?

- Who will do each portion?

- How will this project enhance or benefit your church's ministry?

4. Time-Frame for Project Completion

Start Date: _____ Completion Date: _____

B. Budget Worksheet

1. Sources of Income with Amount of Contribution

Local Church Contribution: _____

Other Sources of Funding: _____
(Include name and amount of any other grants you are applying for.)

Total Amount of Contributions: _____

2. In-Kind Donations (Please give reasonable estimate of value. If necessary, use a separate sheet of paper and attach it to this application)

Volunteer Hours: _____

Equipment: _____

Supplies: _____

Other: _____

3. Project Expenses

General Contractor - Proposed Bid Cost: _____
(Attach bid to application)

Required Materials – Total Materials Cost: _____
(Itemize and attach)

Total Project Expense: _____

4. Calculation for HCF Allocation:

Total Project Expense: _____

Less Total Contribution: _____

HCF Allocation Requested: _____

5. Cost Share

Total Cost of Project: _____ Amount Requesting: _____

===== **For Island Council Use Only** =====

1. Signatures

Moderator: _____ Minister: _____

Island Council President: _____

Telephone: _____ Cell: _____ Email: _____

2. Check off all that apply:

Signatures: ____ Moderator ____ Minister ____ Council President

Minutes: ____ Congregational/Church Council ____ Island Council

===== **Recommendation by Repair & Maintenance Committee** =====

1. Recommendation

Approval: ____ Denial: ____ Grant Amount Recommended: _____

Comments: _____

2. Signature

Committee Chair: _____ Date: _____

===== **Review & Approval of SCHCC Board of Directors** =====

1. Recommendation

Approval: ____ Denial: ____ Grant Amount Approved: _____

Comments: _____

2. Signatures

SCHCC President : _____ Date: _____

SCHCC Secretary: _____ Date: _____

(Revised: October 2016)

**State Council of Hawaiian Congregational Churches
(Hawaii Conference Foundation)
Kahu Richard W Wong Endowment Fund**

On June 25, 1990, Reverend Richard W Wong, Pastor Emeritus of Kaumakapili Church, took a bold step to support Hawaiian churches. On that day, he penned a letter to James Richards of the Hawaii Conference Foundation with the intention of establishing an endowment fund to *kōkua* Hawaiian churches. He transferred all his shares of stock from his investment portfolio to establish the *Kahu Richard W Wong Endowment Fund*.

The purpose of this fund is to assist member churches of the State Council of Hawaiian Congregational Churches with educational, missional, evangelistic, personnel, and building needs, from the earned interest income.

Outreach ministries are given priority over building requests. Churches needing repair and maintenance are encouraged to submit applications to the *Repair and Maintenance of Small Membership Hawaiian Churches Committee*.

The State Council of Hawaiian Congregational Churches was given the responsibility for the administration of this fund. The President, of the Board of Directors for State Council of Hawaiian Congregational Churches, appoints a chairperson for this committee.

PROCEDURES FOR APPLICANT:

- ☐ Complete and sign the application, submit the original plus 4 copies of the application to Island Council President.
- ☐ Attach the signed original plus 4 copies of the Church's Minutes, showing the Action taken for the Grant Request, with the applications.
- ☐ If granted funds, submit an annual report to the Chairperson of the Kahu Wong Committee.

PROCEDURES FOR ISLAND COUNCIL:

- ☐ Review and ensure that the application is completed as required.
- ☐ President and Secretary will sign the application and submit the original plus 4 copies of the application: (Distribution: 1 to applicant, 1 for Island Council, original plus 2 copies to Kahu Wong Committee.)
- ☐ Island Council President submits original plus 2 copies of the application with the **signed Minutes** of the Island Council meeting to Kahu Wong Committee **BEFORE December 31**.

PROCEDURES FOR KAHU WONG COMMITTEE:

- ☐ Reviews applications and makes recommendations to the SCHCC Board of Directors for action.
- ☐ Chairperson signs the Committee's recommendations and provides 1 copy to the SCHCC Secretary and keeps a copy for the Committee records / files.

PROCEDURES FOR SCHCC BOARD OF DIRECTORS:

- ☐ Receive recommendations from the Kahu Wong Committee for final decision.
- ☐ Committee Chairperson notifies applicant of the Board's decision, by letter via U.S. Mail.
- ☐ Committee Chairperson submits the original application and Minutes, showing the Board's decision of grant awards, to the Hawaii Conference Foundation, for disbursement.

(Revised: April 09, 2016)

**State Council of Hawaiian Congregational Churches
(Hawaii Conference Foundation)**

**Kahu Richard W. Wong Endowment Fund
Application Form**

*Please complete every line of the application; using N/A (not applicable) if necessary.
Secure all required signatures.*

Name of Church: _____

Church Address: _____

Mailing Address: _____
Street or P.O. Box City/State Zip Code

Contact Person: _____

Telephone Number: _____ Cell Phone: _____

Email: _____

PURPOSE: The purpose of this program is to assist member churches of the State Council of Hawaiian Congregational Churches (SCHCC) with fulfillment of their church mission through the awarding of monetary grants from the earned interest income of the Kahu Richard W. Wong Endowment Fund.

GRANT AWARDS: Monetary grants shall be awarded to member church applicants for project proposals meeting the criteria set by the program. Any member church of the SCHCC may apply for a grant by submitting a completed application form.

PROGRAM/PROJECTS: A project proposal must serve a religious purpose. It may be submitted for any of the following subjects.

Check project: ____ Music Ministry ____ Outreach ____ Scholarships

____ Social Justice ____ Personnel ____ Worship

____ Christian Education ____ Other(specify)_____

____ Church Repairs (*priority given to Mission work*)

RESTRICTION: “Grants are not to be given to build, maintain, renovate, or support income producing programs / projects.

Name of Church: _____

What is the **Objective(s)** of your program/project? Explain the intent for this project including how your church will accomplish this endeavor. *Attach additional pages, if necessary.*

Describe the **Activities**, which the church hopes to generate, including the audience you hope to reach.

Submit a detailed **Budget**: include materials needed and the cost; labor costs; receipt of other grants.

The **Timeframe**: Describe a timeline for the implementation of the project and its ability to be an ongoing ministry.

The **Evaluation**: Describe how you will monitor this project and evaluate its accomplishments.

(At the completion of this project, you will submit a written evaluation to the Chairperson of the Kahu Richard W. Wong Endowment Fund.)

===== For Local Church and Island Council =====

Name of Church: _____

Total cost of Program/Project: _____ Amount Requested: _____

Contact Person/Applicant: _____ Date: _____

Minister/Moderator: _____ Date: _____
(Moderator will sign, if Church has no Minister)

Island Council President: _____ Date: _____

Island Council Secretary: _____ Date: _____

== Recommendation by Kahu Richard W. Wong Endowment Committee ==

Approval: _____ Denial: _____ Grant Amount Recommended: _____

Comments:

Committee Chair: _____ Date: _____

===== Review & Approval by SCHCC Board of Directors =====

Approval: _____ Denial: _____ Grant Amount Approved: _____

Comments:

SCHCC President: _____ Date: _____

SCHCC Secretary: _____ Date: _____

The Minutes of the _____ SCHCC Board of Directors meeting will be sent to the Hawaii Conference Foundation with the original application.

(Revised: April 09, 2016)

William Kahuaka'i Keli'iho'omalu Scholarship Fund

State Council of Hawaiian Congregational Churches
Hawaii Conference United Church of Christ
1848 Nuuanu Avenue Honolulu, Hawaii 96817
Ph: (808)- 791-5633

Scholarship Policy

Background: The William Kahuaka'i Keli'iho'omalu Scholarship Fund was launched following the passing of Licentiate Kahu, William K. Keli'iho'omalu. Kahu Keli'iho'omalu served as a member deacon of Kawaiaha'o Church for over 20 years. He enrolled in the Lay Pastors School on the Island of Maui and received his certificate as Licensed Minister for the Tri-Isle Moku. Kahu Keli'iho'omalu served at the Paia Hawaiian Protestant Church for a number of years until his retirement. He moved back to his home on the Island of Hawaii in the village of Kalapana, Puna. Upon his death this scholarship was established by a gift from Mrs. Ada Larrison, a friend of the family. She asked that this gift be placed in a Custodial Account with the Hawaii Conference Foundation in the name of "William Kahuaka'i Keli'iho'omalu Scholarship Fund." Over the years' family, friends, and investments raised that fund to \$5,000. It was her request that the principle of \$5,000 remain in the account and the balance of income received would be used for the purpose of providing scholarship to Lay or Ordained ministers for continuing education. If there are no applicants the unused balance would be re-invested in the same account. The custodians of this Fund will be in the care of the State Council of Hawaiian Congregational Churches, or its predecessors.

I. Who Qualifies?

- A) The applicant must be an active member of a church which is a member of the State Council of Hawaiian Congregational Churches.
- B) The applicant must be enrolled in a Licensed Minister School or an accredited Seminary approved by the Scholarship Committee.

II. How to apply for the scholarship?

- A) The applicant must apply through the local Church of which they are an active member.
- B) Application for the William K. Keli'iho'omalu Scholarship can be acquired from the President of the local Island Councils or through the President of the State Council of Hawaiian Congregational Churches.
- C) The Executive Committee of the State Council of Hawaiian Congregational Churches will review and process all applications on October 15th of each year and forward recommendations to the State Council of Hawaiian Congregational Churches Board of Directors for decision.
- D) When an application has been approved, the awardee will be required to sign a Promissory note.

III. What are the requirements and stipulations?

A) Total Scholarship awarded as follows:

1. Seminary -

- a) initial 3 years – not to exceed \$3,000 per completion of education and not exceed \$250 per semester and \$1,000 per school year.
- b) development – 2 years + not to exceed \$2,000 per completion of education and not to exceed \$1,000 per school year.
- c) continuing education – a sum not to exceed \$1,000 per applicant per three (3) year period.

B) The award will be sent to the Seminary or School of Theology by the Treasurer of the State Council of Hawaiian Congregational Churches. In the event that a seminary or School of Theology will not accept the award, it will be sent to the recipient. For Continuing Education recipients, the award will be sent to the applicant.

C) The Seminary recipient will be required to send a copy of their transcript for each semester. Continuing Education recipients will be required to send a copy of their expense receipts. Transcripts and expense receipts shall be sent to the:

President
State Council of Hawaiian Congregational Churches
c/o Hawaii Conference United Church of Christ
1848 Nuuanu Avenue
Honolulu, Hawaii 96817

D) In the event the applicant does not complete his/her course of study, the award then becomes a loan. The applicant shall repay this loan with no interest attached.

E) If the applicant is unable to complete his/her course of study, the State Council of Hawaiian Congregational Churches Executive Committee shall be notified immediately. The Executive Committee will then review the individual's situation and determine whether or not the award becomes a loan.

WILLIAM KAHUAKA'I KELI'IHO'OMALU SCHOLARSHIP FUND
State Council of Hawaiian Congregational Churches

Scholarship Application

Name _____ **Church** _____

Address _____
P.O. Box/Street City/State Zip

SEMINARY to attend _____ **Accepted? Yes / No**

Address _____ **Date to Begin** _____
P.O. Box Street City/State Zip

Certificate or Degree _____ **Amt. Requesting \$** _____
List them: (On Back of this Form)

CONDITIONS:

1. This application must be signed and submitted to your Local Church President or Moderator for approval and signature. Application must be sent to the President of the State Council of Hawaiian Congregational Churches at the following address:
President
State Council of Hawaiian Congregational Churches
c/o Hawaii Conference United Church of Christ
1848 Nuuanu Avenue
Honolulu, Hawaii 96817
2. The State Council of Hawaiian Congregational Churches Executive Committee awards funds to applicants to assist with furthering their education. If the applicant does not complete his/her education, it is understood that he/she will repay the amount used. Upon approval of application by the State Council of Hawaiian Congregational Churches Board of Directors, the applicant will sign a promissory note.
3. This Scholarship may be renewed each year and requires completion and submission of a "Renewal Form." A Renewal Form may be requested from the address above.
4. Application Forms and Renewals must be received by the President of the State Council of Hawaiian Congregational Churches with appropriate signatures and approvals by October 15th of each year.

SIGNATURES and APPROVALS:

Applicant Date _____

President/Moderator or Pastor of your Local Church Date _____

President of the State Council of Hawaiian Congregational Churches Date _____

Form Approved _____
(Revised: October 2016)

WILLIAM KAHUAKA'I KELI'IHO'OMALU SCHOLARSHIP FUND
State Council of Hawaiian Congregational Churches

Scholarship Renewal Form

Name _____ **Church** _____

Address _____
P.O. Box/Street City/State Zip

SEMINARY to attend _____ **Accepted? Yes / No**

Address _____ **Date to Begin** _____
P.O. Box / Street City/State Zip

Certificate or Degree _____ **Amt. Requesting \$** _____

Applied Other Grant/Loans? ___ Yes ___ No **Amt Requested** _____ **Amt. Granted** _____

List them: (On Back of this Form)

GRANTS/LOANS AMOUNT REQUESTED

CONDITIONS:

1. This application must be signed and submitted to your Local Church President or Moderator for approval and signature. Application must be sent to the President of the State Council of Hawaiian Congregational Churches at the following address:
President
State Council of Hawaiian Congregational Churches
c/o Hawaii Conference United Church of Christ
1848 Nuuanu Avenue
Honolulu, Hawaii 96817
2. The State Council of Hawaiian Congregational Churches Executive Committee awards funds to assist applicants with furthering their education. If the applicant does not complete his/her education, it is understood that he/she will repay the amount used. Upon approval of application by the State Council of Hawaiian Congregational Churches Board of Directors, the applicant will sign a promissory note.
3. Application Forms and Renewals must be received by the President of the State Council of Hawaiian Congregational Churches with appropriate signatures and approvals by October 15th of each year.

SIGNATURES and APPROVALS:

Applicant Date _____

President/Moderator or Pastor of your Local Church Date _____

President of the State Council of Hawaiian Congregational Churches Date _____

Form Approved _____
(Revised: October 2016)